

## NON-SLIPPING CHEMICAL TREATMENT

### ANDER B

Ander B is an non-slipping one-component permanent chemical treatment in liquid shape for floorings based on active substances that produce microporosity on the surface.



Suitable for pedestrian traffic areas where prevention of slipping is required.

For porcelanic floorings, gres, glazed stoneware and granite both indoors and outdoors, shower trays or porcelain bathtubs.



Read the technical datasheet carefully before applying



## NON - S L I P P I N G   S Y S T E M



### PATIS

Three-component polymeric mortar with non-slipping texture for applying non-slip embedded strips on site.

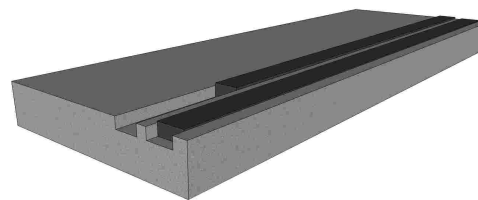

It is an ease of applying product, adaptable to every size, with high mechanical and abrasion resistance. It is used in steps, ramps and floorings in general.



### PATIS

Similar to Patís, with the additional supply of illuminating in the dark.

It is applied for making photoluminescent and non-slipping safety strips on floorings, steps, small surfaces, safety signals, etc..



With light



Without light

Read the technical datasheet carefully before applying

### TEAIS LAMIDER

Laminated compound of two millimetres of thickness made of a textile membrane soaked by two-component resins covered over one side by synthetically encapsulated granular mineral that provides a non-slipping rough surface with high resistance, very useful as safety material even in bad conditions such as ice and water.

Suitable for using on several supports such as walkways, bridges, floors with bad adherence, work places in presence of water, etc.

Ease and fast applying and resistant to chemical agents and oils. It doesn't increase weight and thickness.

Available in a big range of colours and effects:

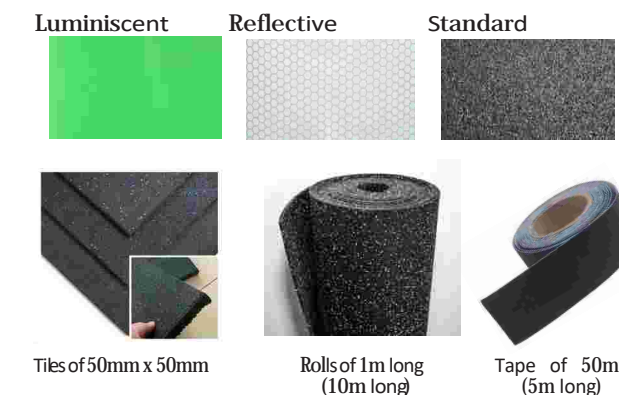

The sticking on the surface must be done with the required adhesive according with needs.

### ANDER F

Ready to use dough with rough texture for making surfaces and non-slipping strips.

Available in several colours:



Read the technical datasheet carefully before applying

## NON-SLIPPING PAINT FOR FLOORINGS



### PAVITAIS PI

**Two-component multipurpose epoxy resin that allows multilayer floorings.**



With non-slipping finishing by seeding with Arcuais. For outdoor application the finishing must be done with Polyurethane 80/20.



### TAIS

Paint based on two-component caoutchouc resin.

It allows the resalization of multilayer floorings with a non-slipping finishing by a seeding of Arcuais.

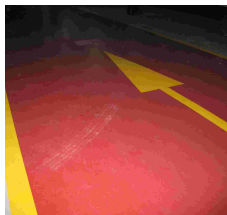

### ARCUAIS

**Selected quartz aggregates natural or coloured, washed and with defined particle size.** Suitable to use on slipping floorings.



## PINTURA DE SEÑALIZACIÓN

### TRAFICOIS

**Caoutchouc-based paint specially formulated for signalling on streets, roads, parkings, etc..**



It is a easy application product that provides high resistance to traffic and can be applied on bitumen supports, concrete, etc...

### GLASS BEADS

**Glass beads are seeded over the fresh painted surface.**

Provides reflectant properties to the surfaces where they are applied making easier the viewing of signalling.

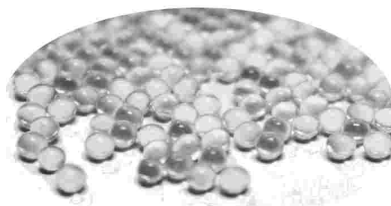

Read the technical datasheet carefully before applying



Teais, S.A.

Avda da Enerxía P.153 Pol. Ind. de Sabón  
15143 Arteixo - A Coruña  
+34 981 60 21 11 info@teais.es

*www.teais.es*



**Prevent accidents**

**PRODUCTS AND SYSTEMS FOR SAFETY ON FLOORINGS.**

