



Adhesives
Additives
Insulation
Release agents
Plasters
Mortars
Cleaners
Waterproofing
Primers
Paints
Coatings
Sealants
Joints
Floors
Wood line
Refractory
Various

Solutions guide

***More than 30 years offering
safe and reliable products***



ABOUT US

TEAIS activity is focused on manufacturing and commercializing products and special systems for construction and industry.

In the 80's the company began its activity manufacturing special products for waterproofing.

Since that moment the main idea has been the manufacturing of products that result suitable solutions for several problems in construction.

The trinomial product-system-solution is the focal point that has been the growing factor and prestige of its products, recognized them always as premium quality and performance.

Over these years satisfaction and recognition of our clients has been the driver of the company growth. Nowadays it is a hallmark which makes us proud.

And this is the way, giving solutions that achieve complete customers satisfaction, where we want keep meeting with you.

WHERE WE ARE

Since its inception TEAIS always has had among its priorities the internationalization of the company according several strategies focused in making the business profitable.

Nowadays the company has presence in several countries of Europe, America, Africa and Asia with commercial agreements or technology transfer that have been functioning for decades.

This is one of the missions in which we are aware of its importance and also keeping special efforts in a world every day more globalized and interconnected.

TEAIS S.A.

*Avda. da Enerxía (Pol. Ind. Sabón) P.153
15143 Arteixo - +34 981 60 21 11*

www.teais.es

RESEARCH AND DEVELOPMENT

Since the beginning, the company has been committed with development and innovation due a higher level of this sense make the companies stronger because this fact makes that the products and process of the companies become different from the competence.

These activities provides social advances such as quality of life, environment improvements, etc. Opting for these values provides advances and major improvements in the competitiveness, having satisfied clients, motivated and committed employees, new employment opportunities and better conditions of life, share our vision with clients and create an environment that encourages the knowledge creation.

As a result of this engagement is the big range of products that we have, some of them worldwide patents.

All the products are a result of a careful research of investigation and development investing a big part of our resources both human and material.

In addition, we opting for training as an essential tool in the positive development. The engagement with investigation, development and innovation has made us one of the companies that more products and systems put on the markets.



SOCIAL RESPONSIBILITY

TEAIS is committed with its active contribution to improve the social welfare at the same time that achieves its aim as a company. This compromise, that is extended both internally and externally, seeks the best balance between the expectations in human plane, social-economical plane and environment, showing our respect for ethic values, common goods, communities and environment.

Therefore, we want serve to society with useful products in fair conditions by creating wealth as efficient as possible respecting dignified working conditions that promotes the security, occupational health and the human and professional development of the employees. Furthermore, we seek the growth of the company and if it is possible in a reasonable way.

We respect the environment trying to avoid any type of pollution, minimizing the waste generation and rationalising the use of natural and energetic resources.

We comply strictly with laws, regulations, rules and customs respecting contracts and compromises and we seek the equitative distribution of the generated richness.



TEAIS

Social responsibility, research and development

SUSTAINABLE DEVELOPMENT

We are aware since the beginning of TEAIS activity that resources are limited and to use them responsibly and in a committed way is an everyday task.

The company always has been working with the conviction that each phase of our production cycle must be sustainable.

For that we check permanently all of our control parameters as our suppliers as our processes from all possible approaches in order to coordinate efforts seeking an higher efficiency with the most suitable resources.

Since the beginning several decades ago, when the environment policies were still in early stages TEAIS already had specific processes.

Waste water coming from industrial processes, after been properly purified, are mainly reused to irrigate landscaped areas.

Waste solvents are regenerated and reused.

Fumes from combustion are neutralized by catalysing with water curtains.

Each and every one of the processes are checked in systematic manner in order to achieve the continuous improvement.



QUALITY & CERTIFICATION

The concept of quality that TEAIS has implemented covers all the activities of the company.

It comprises all and each of their members which are committed in its achievement.

Our philosophy is the whole dedication to client and covers all the actions in the company, having to satisfy the wishes of final clients and even more than they expected.

For that, we establish policies and objectives, we make plans to achieve the objectives, we have the necessary resources to enable this plans, controls are established and a motivation system is created.

Since 1995 TEAIS S.A. is a certified company under ISO norms, actually ISO 9001 and permanently reaffirm our commitment with the total quality. At TEAIS S.A. each and every one of the employees believe and are committed in the continuous improvement, "Kaizen" as positive tools of evolution for the future that we build.

TEAIS has obtained DITE 11/0299 for its thermic insulating system for the exterior side of facades (SATE) called TEAIS TERM that allows renew facades (and also indoor walls) with the best aesthetic and functional properties from the point of view of thermal insulation and waterproofing, achieving at the same time a quite energy saving that makes possible to give back the money paid for renewing the facade less than 5 years. The fact of obtaining DITE for TEAIS TERM confirms its excellent performance.

Repos P and Repos R monolayer mortars has DIT 429 and 430 respectively.

"El Documento de Idoneidad Técnica Plus" (DIT Plus) or "Technical Suitability Document Plus" in its name in English language is a favourable technical appreciation of Instituto de Ciencias de la Construcción Eduardo Torroja that basing in DIT procedure assess points not included in CE regulations.

Due this fact, TEAIS one coat mortars have all the positive valuations according their performance.



ADHESIVES

adhpi	13
adirres	3
apoais	5
cecois	8
cecois epoflex	12
cecoisflex	9
cecois fraguado r.	7
cecois piscinas super blanco	8
cecois porcelanato	9
cecois térmico AT	7
colte	12
contactis aqua	14
epoais 10	10
epoais carbono	11
epoais H	11
epoais INY	10
lastois bond	14
morvi	6
peganel	6
plasto-2	5
unipis	3
unirres-N	3
unirres-NC universal	4
unitais	4

ADDITIVES

acelerais	17
aditex	23
aglutais 30-50	20
clais	24
fiais	18
hidais	18
hidro 1	19
iais	19
plais N	22
plais super	22
retardois	24
teais adi term	23
teais latex	21
teais rapical	17
teais sulfor	20
teais termic latex	21

INSULATION

climais	27
fibras 150	29
fibras 300	30
fibra polipropileno	27
fibrotais	28
grapais	31,33
punzonais	29

teais fibracer	28
teais grap dentada	34
tejaais 5-150	30
tejaais carbono	31
termoplak	32

RELEASING AGENTS

deais ecológico	38
deais lava	39
deais mh	39
deais poly	37
deris	40
desmur	38
despol	37
lais	40

PLASTERS AND SPECIAL MORTARS

capilais	56
cemrais	54
duoasfalt	48
emplais exteriores	45
emplais int. renovación	45
emplais interiores	46
emplascem	44
hormifluis	46
hormigrout	47
hormipavi fast	49
hormitix	47
morfluis	52
moris	49
moris capa fina	50
moris inhibidor	51
morpi base cal	52
morsis recrecidos	56
panis	55
plastocal	43
rais plug	43
refracmor	48
rocamol prefabricados	53
rocamol rustico	53
teais alisador monocapa	50
teais baches	51
teais protector N	55
teais recrecidos R35	54

CLEANERS

coais super	63
coais super gel	63
desincrustois	60
disolvente de limpeza	60
limsal	64
lioxis	64

lipis	59
saneante de moho	59
teais cleaner	61
teais deter	61
teais lim-ps	62
teais nutrimad	62

WATERPROOFING

cepis	77
lastoflex OC	73
lastois canalones	76
lastois capa intermedia	74
lastois FHCV	73
lastois fibro	70
lastoisflex	74
lastois IP	77
lastois ms liquido	68
lastois RS	75
lastois techumbres	69
lastosalis	67
propis	76
repais	70
repais aniverdin	72
repais efecto memoria	71
repais hidroconsolidante	71
teais antiverdin seguridad	75
teais barrera capilar	67
teais capi-c	68, 79
teais cubierta jardín	80
teais ferroprotec iny.	81
teais idrof	72
teais impercem	78
teais SK film	69

PRIMERS

ac silver CR	93
antigrafitais	89
autais impi	93
corrofin	92
endupis	94
epoiter 90/10	97
epozinc	89
fijopi	96
impridur	96
imprimación XP	90
imprimais	95
imprimais MR	92
imprimais MU	95
metais GPB	91
oxitais	90
sellador adobe	94
teais pda	97
teais protector N	91

PAINTS

<i>acrilais</i>	105	<i>lastois SPT</i>	130	<i>protector microcimento</i>	152
<i>antimohais</i>	109	<i>rejutais</i>	134	<i>resimpres</i>	153
<i>brepais</i>	110	<i>rejuntais plus</i>	134	<i>tais</i>	151
<i>depis antimoho</i>	108	<i>teais block</i>	137,138	<i>teais microcimento</i>	147
<i>epoais D</i>	114	<i>teais figrap</i>	137	<i>teais pavimentos inf.</i>	155
<i>epox aqua</i>	114	<i>teais jun</i>	131	<i>tradur</i>	148
<i>humotais</i>	107	<i>teais juncril</i>	133		
<i>imade</i>	112	<i>teais junplas</i>	131	WOOD LINE	
<i>pincals</i>	112	<i>vitrojun</i>	136	<i>carcomais</i>	161
<i>pinsil D</i>	105			<i>emplais M</i>	162
<i>pintis lisa</i>	108	FLOORS		<i>madepois líquido</i>	162
<i>pintox</i>	110	<i>ander B</i>	154	<i>madepois pasta</i>	163
<i>pistais</i>	109	<i>durepox autonivelante</i>	145	<i>promadis</i>	163
<i>poliuretano 80/20</i>	111	<i>durepox tixotrópico</i>	146	<i>teais lasur</i>	161
<i>revetais</i>	106	<i>durimpres</i>	147		
<i>rocais artístico</i>	113	<i>durimpres rehabilitación</i>	148	REFRACTORY LINE	
<i>teais homiprotec</i>	111	<i>duroais capa continua</i>	153	<i>teais hormi-ref</i>	167
<i>teais homocolor</i>	106	<i>duroais parcheo</i>	154	<i>teais mod-cer</i>	168
<i>teais siloxano</i>	107	<i>epoais PIN</i>	149	<i>teais pap-cer</i>	169
<i>teais termopin</i>	113	<i>epoais vinicola</i>	150	<i>teais pasta refractaria</i>	169
		<i>eslurris sintético</i>	149	<i>teais pin-ref</i>	168
		<i>lacuris D</i>	145		
		<i>paviais AC</i>	150	OTHERS	
		<i>pavitaís PI</i>	146	<i>aplijun</i>	170
		<i>pinlurris</i>	151		

COATINGS

<i>estucal</i>	117
<i>estucal satinado</i>	117
<i>grais</i>	120
<i>minerplast</i>	121
<i>relais</i>	120
<i>relais siloxano</i>	121
<i>repois P</i>	118
<i>repois R</i>	118
<i>revogacal</i>	119
<i>revogacal rústico</i>	119
<i>teais jardín vertical</i>	124
<i>teais piscina playa</i>	123
<i>teais term</i>	122

PUTTIES AND JOINTS

<i>autoemplais</i>	127
<i>epoais jun</i>	136
<i>espumais</i>	127
<i>expais jun</i>	135
<i>fijopol</i>	128
<i>fijopox</i>	128
<i>junta laminar lastois</i>	133
<i>lastois 10</i>	132
<i>lastois hidroexpan</i>	135
<i>lastois MS</i>	129
<i>lastois POL</i>	130
<i>lastois POL líquido</i>	129
<i>lastois PSF</i>	137
<i>lastois roca</i>	132



Learn more about our complete product range:

www.teais.es

Acelerais	17	Emplais exteriores	45	Lacuris D	145
acrilais	105	emplais int. renovación	45	lais	40
ac silver CR	93	emplais interiores	46	lastoflex OC	73
adhpi	13	emplais M	162	lastois 10	132
adirres	3	emplascem	44	lastois bond	14
aditex	23	endupis	94	lastois canalones	76
aglutais 30-50	20	epoais 10	10	lastois capa intermedia	74
ander B	154	epoais carbono	11	lastois FHCV	73
antigrafitais	89	epoais D	114	lastois fibro	70
antimohais	109	epoais H	11	lastoisflex	74
aplijun	170	epoais INY	10	lastois hidroexpan	135
apoais	5	epoais jun	136	lastois IP	77
autais impri	93	epoais PIN	149	lastois MS	129
autoemplais	127	epoais vinicola	150	lastois ms liquido	68
		epoiter 90/10	97	lastois POL	130
Brepois	110	epox aqua	114	lastois POL liquido	129
		epozinc	89	lastois PSF	137
Capilais	56	eslurris sintético	149	lastois roca	132
carcomais	161	espumais	127	lastois RS	75
cecois	8	estucal	117	lastois SPT	130
cecois epoflex	12	estucal satinado	117	lastois techumbres	69
cecoisflex	9	expais jun	135	lastosalis	67
cecois fraguado r.	7			limsal	64
cecois piscinas super blanco	8	Fiais	18	lioxis	64
cecois porcelanato	9	fibrais 150	29	lipis	59
cecois térmico AT	7	fibrais 300	30		
cemrais	54	fibra polipropileno	27	Madepois líquido	162
cepis	77	fibrotais	28	madepois pasta	163
clais	24	fijopi	96	metais GPB	91
climais	27	fijopol	128	minerplast	121
coais super	63	fijopox	128	morfluis	52
coais super gel	63			moris	49
colte	12			moris capa fina	50
contactis aqua	14	Grais	120	moris inibidor	51
corrofin	92	grapais	31,33	morpi base cal	52
				morsis recrecidos	56
Deais ecológico	38	Hidais	18	morvi	6
deais lava	39	hidro 1	19		
deais mh	39	hormifluis	46	Oxitais	90
deais poly	37	hormigrout	47		
depis antimoho	108	hormipavi fast	49	Panis	55
deris	40	hormitix	47	paviais AC	150
desincrustois	60	humotais	107	pavitaís PI	146
desmur	38			peganel	6
despol	37	lais	19	pincals	112
disolvente de limpeza	60	imade	112	pinlurris	151
duoasfalt	48	impridur	96	pinsil D	105
durepox autonivelante	145	imprimación XP	90	pintis lisa	108
durepox tixotrópico	146	imprimais	95	pintox	110
durimpres	147	imprimais MR	92	pistais	109
durimpres reha-		imprimais MU	95	plais N	22
bilitación	148			plais super	22
duroais capa continua	153	Junta laminar lastois	133	plasto-2	5
duroais parcheo	154			plastocal	43

<i>poliuretano 80/20</i>	111	<i>Tais</i>	151	<i>teais nutrimad</i>	62
<i>promadis</i>	163	<i>teais adi term</i>	23	<i>teais pap-cer</i>	169
<i>propi</i>	76	<i>teais alisador monocapa</i>	50	<i>teais pasta refractaria</i>	169
<i>protector microcimento</i>	152	<i>teais antiverdin seguridad</i>	75	<i>teais pavimentos inf.</i>	155
<i>punzonais</i>	29	<i>teais baches</i>	51	<i>teais pda</i>	97
Rais FN plug	43	<i>teais barrera capilar</i>	67	<i>teais pin-ref</i>	168
<i>refracmor</i>	48	<i>teais block</i>	137,138	<i>teais piscina playa</i>	123
<i>rejuntais plus</i>	134	<i>teais capi-c</i>	68,79	<i>teais protecor N</i>	55
<i>rejutais</i>	134	<i>teais cleaner</i>	61	<i>teais protecor N</i>	91
<i>relais</i>	120	<i>teais cubierta jardín</i>	80	<i>teais rapicol</i>	17
<i>relais siloxano</i>	121	<i>teais deter</i>	61	<i>teais recrecidos R35</i>	54
<i>repais</i>	70	<i>teais ferroprotec iny.</i>	81	<i>teais siloxano</i>	107
<i>repais aniverdin</i>	72	<i>teais fibracer</i>	28	<i>teais SK film</i>	69
<i>repais efecto memoria</i>	71	<i>teais figrap</i>	137	<i>teais sulfor</i>	20
<i>repaishidroconsolidante</i>	71	<i>teais grap dentada</i>	34	<i>teais term</i>	122
<i>repolis P</i>	118	<i>teais homiprotec</i>	111	<i>teais termic latex</i>	21
<i>repolis R</i>	118	<i>teais homocolor</i>	106	<i>teais termopin</i>	113
<i>resimpres</i>	153	<i>teais hormi-ref</i>	167	<i>tejaais 5-150</i>	30
<i>retardois</i>	24	<i>teais idrof</i>	72	<i>tejaais carbono</i>	31
<i>revetais</i>	106	<i>teais impercem</i>	78	<i>termoplak</i>	32
<i>revogacal</i>	119	<i>teais jardín vertical</i>	124	<i>tradur</i>	148
<i>revogacal rústico</i>	119	<i>teais jun</i>	131	Unipis	3
<i>rocaais artístico</i>	113	<i>teais juncril</i>	0133	<i>unirres-N</i>	3
<i>rocamol prefabricados</i>	53	<i>teais junplas</i>	131	<i>unirres-NC universal</i>	4
<i>rocamol rustico</i>	53	<i>teais lasur</i>	161	<i>unitais</i>	4
Saneante de moho	59	<i>teais latex</i>	21	Vitrojun	136
<i>sellador adobe</i>	94	<i>teais lim-ps</i>	62		
		<i>teais microcimento</i>	147		
		<i>teais mod-cer</i>	168		



adhesives

ADHERENCE IMPROVERS

adirres
unires n
unirres nc universal
unitais

INSULATION

apois
plasto2
peganel

GLASS BLOCK

morvi

TILE ADHESIVES

cecois fraguado rápido
cecois térmico AT
cecois
cecois piscinas super blanco
cecois porcelanato
cecoisflex

CONCRETE

epoais 10
epoais INY

CARBON FIBER

epoais carbono

METALS

epoais h

NON-POROUS SUPPORTS

cecois epoflex

ROOF TILES

colte

STONES

adhpi
unipis

PLASTICS

contactis aqua

ELASTIC AND WATERPROOF

lastois bond

Learn more about our full range of products
<https://www.teais.es>

bonding agent for surfaces with low adherence

adirres

Adirres is a product that comes in paint form.

Bonding agent to apply on supports with low adhesion. Its use allows the application on ceramic surfaces both walls and floors for subsequent application of claddings, levelling pastes, cement-base adhesives, etc.

It's recommended for floor due to haven't a permanent taking, it allow to be able to walk on it once dry.

*Packaging: 0,75 l, 4 l, 16 l
Consumption: until 4 sqm/l*



adherence improvers

adherence improver agent for surfaces with low adherence

unirres - N

Unirres-N is a dispersion of water-based acrylic copolymers, and special additives that is applied as a paint on the supports where a better adherence is required

Unirres-N is a suitable resin for improving the adherence between claddings and surfaces with low adherence such as expanded polystyrene, extruded polystyrene, wood, etc.

For making cement-based mortars on concrete supports or existing mortar as an adherence improver. Union abutments with walls, mortar improver additive. Suitable for cement mortar, plaster or plasterboard. It can be used on various supports such as concrete, mortar, brick, stone, artificial stone, cement, polystyrene, wood.

*Packaging: 1 l, 5 l, 25 l
Consumption: 4 to 5 sqm/l*



adherence improvers

unirres - NC universal

universal adherence improver agent which doesn't produce corrosion on metals



Unirres-NC is a resin based on polymers which is used to improve the adherence of mortars on metallic, wooden, mortars, paints, etc avoiding corrosive processes.

The product is applied to obtain a suitable adherence between supports mainly metallic, wooden surfaces, paints and cement-based mortars, lime or gypsum.



*Packaging: 1 l, 5 l, 25 l
Consumption: 4 to 5 sqm/l*

unitais

adherence improver agent



Unitais is a powder product with cement-based formulation, charges and additives which can be used mixed with water or powder according the type of application.

It is used as an improver of adherence on screeds of concrete. As improver of adherence in the joints between concrete and concrete-walls which are not made in once stage.



*Packaging: 25 kg
Consumption: 1,5 to 2,5 kg/sqm according use*

powder adhesive for polystyrene sheets and rock wool

apois

Apois is a powder adhesive, when mixed with water, it forms a mortar specially designed for sticking and smoothing expanded polystyrene sheets and rock wool to construction supports. It is suitable for External Wall Thermal Insulation System

Ideal for joining polystyrene foam or rock wool to construction supports, on concrete walls, brick partition walls, renders, filled walls with mortars and all the surfaces that require insulation.

To install ETICS system.

Packaging: 25 kg

Consumption: 3,0 kg/sqm on 2mm thickness



insulation

plastic water-based mortar

plasto 2

Plasto-2 is a plaster or mortar with extraordinary plasticity, which is suitable for regularization layers onto expanded and extruded polystyrene surfaces, as well as adhesive for these materials, with traditional building holders.

It is suitable as an adhesive layer for Integrairs (polystyrene sheets) in thermal and acoustic insulation systems placed onto concrete, cement plaster, asbestos cement, etc.

The product can be applied both indoors and outdoors.

Packaging: 25 kg

Consumption: 3,0 kg/m2 on 2mm thickness



insulation

peganel

special cement-based adhesive for fixing thermal insulation panels.



Peganel is an adhesive with waterproofing properties special for fixing of insulation panels based on glass wool or other mineral wools.

It is used for fixing glass wool and other mineral wools on brick supports, concrete blocks, claddings, etc.

The fixing with PEGANEL ensure waterproofing protection against thermal insulation keeping the waterproofing, avoiding condensations.



Packaging: 25 kg

Consumption: 6 to 8 kg/sqm

morvi

special mortar for placing glass paving block



Morvi is a powder product to be prepared with water. He is formulated in base of modified cement with special resins and thin aggregates specially selected. Once it is blended with water becomes in a thixotropic paste. Ideal for the placement of glazed blocks.

For installing glass blocks so as to provide flexibility, waterproofing and resistance to changes in temperature.



The product can be used in interiors and exteriors. It is recommended to use the synthetic reinforcing structure ARMASIN for exterior applications. It is mortar characterised for its waterproofing property.

Packaging: 5 kg, 25 kg

Consumption: 15 kg/m² with joint of 1 cm

fast setting-time adhesive for laying bricks, tiles and ceramics

cecois
fraguado rápido

Cecois Fraguado Rápido is a fast setting-time powder cement-based adhesive formulated in base of modified cement with special additives and fine aggregates with selected particle-size.

It is suitable for laying bricks, tiles, ceramics, marble, glazed, etc. In kitchens, bathrooms, toilets, laboratories, hospitals, etc. Placement of tiles and slate and sloped roofs.

Both indoors and outdoors.

Recommended for uses that require quick setup.

Packaging: 1,5 kg , 25 kg

Consumption: 3,0 kg/sqm on 2mm thickness



tile adhesives

adhesive for temperatures up to 300°C

cecois
término AT

Cecois Térmico AT is a special adhesive for the installation of claddings (tiles, stone) in areas that are exposed to heat, such as chimneys, stoves, areas close to an oven, etc.

The product is a ready-to-use paste.



tile adhesives

Packaging: 25 kg

Consumption: 3,0 to 5,0 kg/sqm according use

cecois**tile adhesive for laying tiles, ceramic tiles and ceramics**

Cecois is a powder cement-based adhesive, formulated in base on cement modified with special additives and selected fine aggregates. Cecois must be mixed with clean water in the recommended proportion and is used for sticking tiles, platelets, ceramics, etc.

Type C1 T according to UNE-EN 12004

it can be used in laying tiles, platelets, ceramic tiles, marble, etc., in kitchens, bathrooms, toilets, laboratories, hospitals, etc. Both indoors and outdoors. To fix tiles, slates, etc. in pitched roofs.



Packaging: 1 kg, 5kg and 25 kg

Consumption: 3,0 kg/sqm on 2mm thickness

cecois
piscinas superblanco**adhesive for ceramic tiles on pools**

Cecois Piscinas Super Blanco is cement-based adhesive, polymers, special additives and aggregates with selected grading.

The adhesive is mixed with water and is used for laying tiles on pools and it is used as a grout both for ceramic or mosaics.



Packaging: 25 kg

Consumption: 3,0 kg/sqm on 2mm thickness

adhesive for laying tiles and mosaics

**cecois
porcelanato**

Cecois Porcelanato is a glue cement presented in powder based on modified cement with special resins and specially selected thin aggregates.

Type C1 T E according to UNE-EN 12004

Cecois Porcelanato is designed to present an excellent grip with low absorption pieces as porcelain stoneware or ceramic pieces with a significant size.

Suitable for indoor or outdoor.

Packaging: 25 kg

Consumption: 3,0 kg/sqm on 2mm thickness



tile adhesives

tile adhesive of mixed binders

cecoisflex

Cecoisflex is a high performance (C2), flexible cementitious adhesive (S1) with extended open time (E) and no vertical slip (T) for all kinds of ceramic tiles

It is suitable for laying cladding of marble, granite, big or small stone for indoors and outdoors, for placing ceramic, gres, clay, porcelain, low absorption ceramic, on supports made of plasteboard and also for radiant heating floors.

C2 T E S1 according to UNE-EN 12004

Packaging: 25 kg

Consumption: 3,0 kg/sqm on 2mm thickness



tile adhesives

epoais iny

epoxy adhesive for injections, two component and low viscosity



Epoais Iny is a high fluidity epoxy adhesive, which hardens without retraction and acquires high mechanical strength.

It is used to inject cracks and structural crevices in order to obtain a monolithic piece. Injected fissures should be static. Epoais Iny is also used in the consolidation of microcracks made by concrete retractions.

Can be used in concrete, mortar, stone, steel and wood. Besides paste both sides of the crack, it is also an effective barrier against water leaks that may occur in cracked parts.



Packaging: 1 Kg

Consumption: 1,05 kg for each lt of volume to be filled

epoais 10

bi-component adhesive based on epoxy resins



Epoais 10 is an adhesive based on epoxy resins, presented in two parts which are mixed before using. Epoais 10 has a suitable viscosity to allow the application as a paint, in both vertical and horizontal surfaces.

It is used in binding building materials, its most specific application is as a bonding bridge between new concretes and existing concretes.



Packaging: 1,5 kg , 8 kg

Consumption: 2 sqm/kg into concrete union

epoxy adhesive for carbon mesh bonding

epoais carbono

Epoais Carbono, is a two component epoxy adhesive with very good strength and special gel-like consistency.

for bonding Tejais Carbono in structural reinforcement systems and Teais Carbo Lam

In structural reinforcement systems, on beams, pillars, and other structures that require reinforcement.



carbon fiber



Packaging: 4,4 kg

Consumption: 0,5 to 0,7 kg/sqm depending on support

bi-component thixotropic adhesive based on epoxy resins

epoais h

Epoais H is an epoxy adhesive presented in two parts which are mixed before using. Its consistency is pasty thixotropic, which allows it to glue pieces together both vertically and horizontally, and provides a certain refill capability.

It is used for bonding cured concrete parts together. Union of metal, marble, natural or synthetic stones, and similar choices. In anchoring of iron, flange plates, to fill cracks.

As repair mortar for small surfaces such as edges or ridges, holes or voids, repair joints and cracks edges.



metals



Packaging: 3,54 kg

Consumption: 2,0 kg/sqm according application

cecois epoflex

flexible epoxy adhesive for fixing claddings on non-absorbent supports



Cecois Epoflex is a special adhesive based on Epoxi flexible resins with good thixotropy and very high adherence in many supports.

It is applied for fixing all types of claddings on surfaces where the adherence is low (plastic, ceramic, glass, metals, etc.)

Suitable for indoor and outdoor.



Packaging: 4,4 kg

Consumption: 2,0 to 2,5 kg/sqm according application

colte

coloured adhesive for the placement of tiles and gable ends



Colte is a powder adhesive to mix with water. It is coloured according the most common colours of the tiles on market in order to improve the aesthetic appearance.

The product improves the aesthetics of the installation, perform finishes, the first rows of laying on the edges of chimneys, etc.

The product has water repellent properties which improve the impermeability of the roof.



Packaging: 25 kg

Consumption: 3 to 4 sqm per 25 kg bag

adhesive for laying stone slabs

adhpi

Adhpi is a powder adhesive used for laying stone slabs. It has a higher resistance than cement-base adhesives, quick drying, with improved mechanical resistance and waterproofing properties. Its use reduces the risk of damp patches and efflorescence.

Used as adhesive for elements made of marble and granite, used on floor pavements and vertical supports such as: granite attachments, polished marble attachments, baseboards, plinths, door and window frameworks, rise and fall of stairs, etc.

*Adhpi G, allows the installation on brick in greater thickness than a conventional glue
Type C2 T according to UNE-EN 12004.*

Packaging: 25 kg

Consumption: 1,5 kg/sqm on 1mm thickness



stones

fast adhesive for marble, granite and stone.

unipis

Unipis is a two-component product based on polyester resin, formulated as a fast setting time to join pieces of marble, granite and stone (natural and artificial). After the two-component blending is done the product becomes in a thixotropic paste easy to apply both in horizontal and vertical.

It is used in construction, repair and restoration of pieces of marble, granite and stone (natural and artificial). Also can be used for small fillings of flooring concrete hollow in terrazzo, slabs, etc because it can be polish achieving high resistance against abrasive wear and high adherence.

Packaging: 1,5 Kg, 8 Kg

Consumption: 8 sqm/Kg



stones

contactis aqua

water contact adhesive



Contactis Aqua is a contact adhesive based on copolymers, special additives and micronized fillers, specially developed for the bonding of light and low absorption elements. Apply with a brush, fine tooth trowel on each side. Allow to dry and press until the adhesive dries.

The product is suitable for surfaces that can be attacked by solvents (polystyrene, foams, plastics, textiles).

Indoor use



Packaging: 4 kg

Consumption: 1sqm/l according to support absorption

lastois bond

one-component elastic adhesive based on polymer.



Lastois Bond is an adhesive based on MS polymer that polymerizes by the action of environmental dampness. Ease of applying and handling. In putty consistence can be applied by spatula.

It is suitable for elastic sticking of wood, parquet, etc.

For the elastic and waterproof sticking on balconies and terraces, old tiles, patios, kitchens, bath-rooms and another surfaces exposed to the weather.



Packaging: 15 kg

Consumption: 1,0 to 2,5 kg/sqm

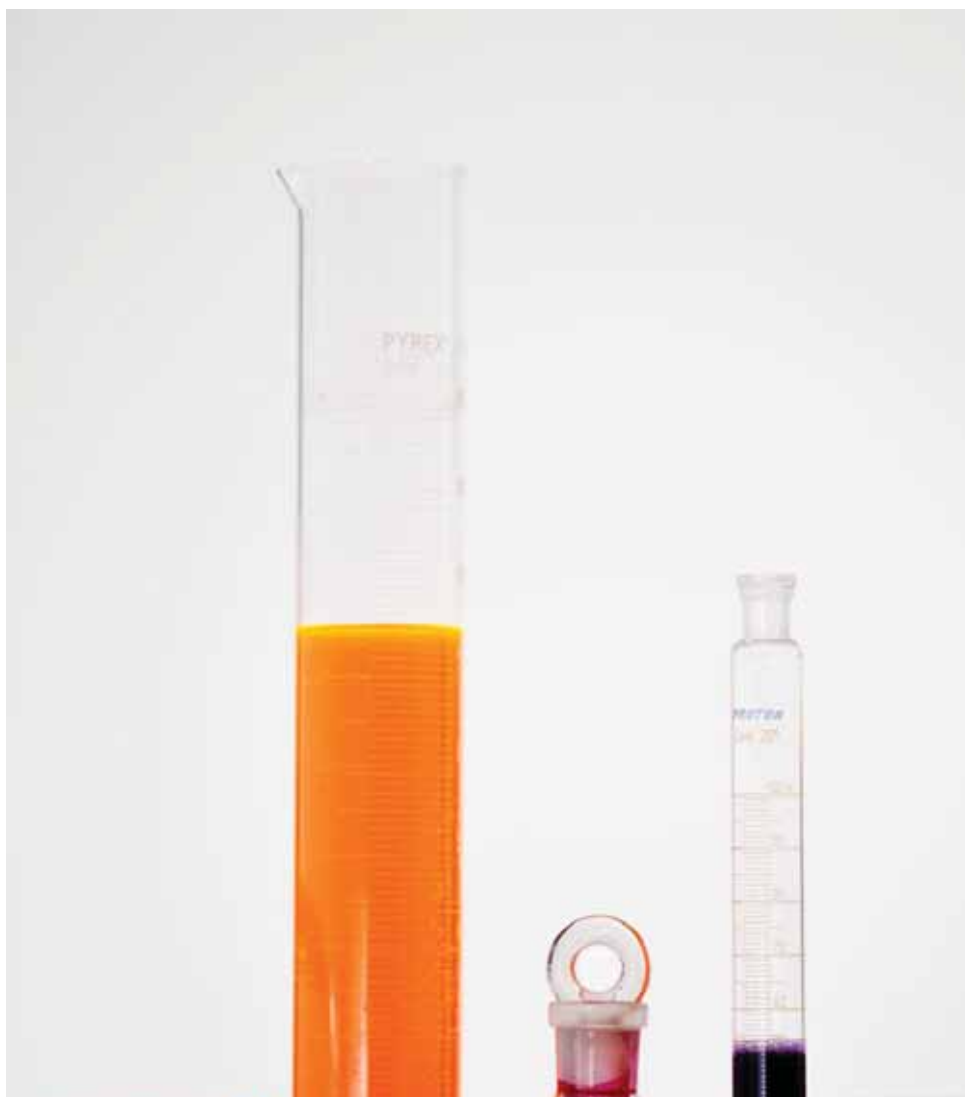

additives



ACCELERATORS

acelerais
teis rapicol

ANTIFREEZE

fiais

WATERPROOFING

hidais
hidro1
iais

IMPROVERS

aglutaís 30-50
teis termic latex
tais sulfor

ADHESION PROMOTER

teis latex

PLASTICISERS

plais N
plais super

FLUIDIZER

teis adi term

TEXTURIZER

aditex

RETARDANTS

retardois

DYES

clais

Learn more about our full range of products
www.teais.es

accelerator for setting time for mortar and concrete

acelerais

Acelerais is a liquid additive that acts both as an accelerator for the setting time for mortars and concrete. It also acts as anti-freeze agent allowing the formation of concrete at low temperatures.

*it is used to obtain quick turnovers, concrete characterised by high initial and final resistances, concrete structures that require the quick formation of passable decks, concrete at low temperatures, with water contact and even when completely immersed in water, etc.
UNE-EN 934(2) and (3)*

*Packaging: 1 l, 5 l, 25 l, 200l, 1000 l
Consumption: 0,25 to 1 l per cement bag*



accelerator

accelerator and activator for glue cement

**teis
rapicol**

Teais Rapi Col is an energetic liquid additive with high concentration to improve the setting of glue cements. Based on mineral composites of high concentration.

It is applied mainly in works that requires a quick starting up or in those that the setting is required to improved because the low temperatures.



*Packaging: 1 l, 5 l, 25 l, 200 l
Consumption: 6 to 10% of water mix*

accelerator

fiais

antifreeze and accelerator liquid



Fiais is a liquid additive in mineral base with high concentration that because of its exothermic reaction is able to decrease the freeze point of mix-water and increases the hydration of the cement allowing the concreting at low temperatures. (UNE-EN 934-2 and 3)

it is used mainly on winter as a mortar and concretes additives allowing the concreting at low temperatures, also below 0°C.



*Packaging: 1 l, 5 l, 25 l, 200 l
Consumption: 0,25 to 1 l per cement bag*

hidais

waterproofing powder for mortars and concretes



Hidais is a powder product that mixed with Portland cement in mortars and concretes, provides excellent water-repellent properties, ensuring their impermeability, without losing other features. Contains no chlorides. (UNE-EN 934-2)

It can be used in the reinforced concrete of foundations, galleries and underground tunnels, docks, dikes, etc.

In the impermeabilization of swimming pool plasters, water tanks, facades, outdoor walls, precasts, etc.



*Packaging: 1 kg, 25 kg
Consumption: 0,5 kg per cement bag*

waterproofing for mortars and concretes

hidro 1

Hidro-1 is a liquid which mixed with mortars and concretes it adds them waterproof properties.

it's used to improve the impermeability of concretes and mortars.

The mortars and concretes added with Hydro-1 can be used in coatings of water tanks, swimming pools, facades, foundations, basement walls. Suitable for underground works, tunnels, galleries, foundations, retaining walls, canals, irrigation ditches, etc.



Packaging: 1 l, 5 l, 25 l

Consumption: 0,5 l per cement bag

waterproofing

plasticizer liquid and waterproofing agent for mortars and concretes

lais

lais is a thick/pasty liquid that added with mixing-water in the right proportions, confers plasticity and waterproofing to mortars and concretes.

Improves with efficiency the waterproofing and workability of mortars and concretes. For all purposes.

Very good performance due to its high concentration.



Packaging: 1 l, 5 l, 25 l, 200 l

Consumption: 1lt per 400 kg of cement and 1l for 200 kg of cement in precast concrete

waterproofing

aglutais 30-50

plastic resin to improve mortars and concretes



Aglutais 30-50 is an emulsion based on plastic resin Butadiene Styrene type, which added to the mixing water in mortars and concretes provides an increase and improvement of mechanical and chemical resistance.

Aglutais greatly improves adhesion, cohesion, thixotropy etc. *Aglutais 30-50* resists saponification.

It's used to improve cohesion, compressive and flexural mechanical resistance, adhesion, reduces plastic shrinkage etc.

It's used in any sand and cement mortars to which this properties want to be improved.

Packaging: 1 l, 5 l, 25 l

Consumption: Aprox. 26 l per 100 kg of cement



teis sulfor

additive improver for resistance to sulphates



Teis Sulfor is a liquid additive based on copolymers and inorganic compounds that improves the resistance to sulphates and sea water

it is suitable for requirements of resistance in mortar and concrete to seawater, marine environment, sulphates, etc



Packaging: 1 l, 5 l, 25 l

Consumption: 2% of cement weight

additive improver of cement-based adhesives for radiant heating floorings

**teis
termic latex**

Teais termic latex is an additive based on a mixing of copolymer resins, additives and aqueous vehicle.

It's improves substantially the properties of cement-based adhesives for the application of coverings on radiant heating floorings.



Packaging: 5 l, 25 l

Consumption: 1 l per 2 l of water

improvers

emulsion adhesive that improves grouts and mortars

teis latex

Teais Latex is an emulsion based on copolymers which provides substantial gains to mortars, grouts and cements in general as in their increases of mechanical properties and improvement of adherence.

It is used for improving adhesive groutings and grouts for clogging pores, masonry mortars in general, glue-cements, low-thickness mortars, to improve adherence on several supports, to improve the elasticity and flexibility. It reduces the crack risk and improves the impermeability, the abrasion resistance and chemical resistances.



Packaging: 1 l, 5 l, 25 l

Consumption: Depending on use

adhesion promoter

plais N

plasticizer for concrete and mortar



Plais N is a plasticizer for mortar and concrete, which is ideal to obtain an excellent plasticity, greatly facilitating their manageability and improving their work placement.

It's used when it's necessary to improve the workability of mortar and concrete, to slightly reduce the water/cement ratio, to achieve a better finish of the molded parts, to increase mechanical strength. Cohesion increases avoiding segregation, increases the hardened mortar's resistance to frost.

Does not change the setting and hardening times. UNE-EN 934(2) and (3)



Packaging: 1 l, 5 l, 25 l, 200 l

Consumption: 1 l for 2500 kg of cement

plais super

concentrate plasticizer for concrete and mortar



Plais S is a concentrate plasticizer for mortars and concretes.

It is used in mortars and concretes that require better workability, better thixotropy a moderate reduction in the ratio W / C , a better finish, an improved compactness, improved water resistance, reduced drying shrinkage, improve adherence cement-aggregate-armor, etc.

UNE-EN 934(2) and (3)



Packaging: 1 l, 5 l, 25 l, 200 l

Consumption: 1 l per 10.000 kg of cement

additive for mortars with radiant floors

**teais
adi-term**

Teais Adi-Term is a liquid additive which is able to achieve compact mortars and improves their thermal conductivity.

It is used for compacting mortars on floors with radiant heating.

To increase the heating floor yield.



Packaging: 5 l, 25 l

Consumption: 1,5 % of cement weight

fluidizer

texturizer additive for synthetic products

aditex

Aditex is a texturizer powder additive, of mineral-nature and colourless.

It is used for texturing all kind of coatings or synthetic paints. Mainly in pavements applications, ramps, stairs, which a no-slipping texturized surface must be achieved.

Suitable for the application of paint or coating.



Packaging: 0,8 kg, 20 kg

Consumption: Depending on use

texturizer

retardois

setting retarder for mortar and concrete



Retardois is a liquid additive setting-time retardant for mortars and concretes.

It's suitable for delaying the setting-time, with hot weather, when a big quantity of concrete to place is required, when it requires to avoid the concreting joints, when it transported over long distances, with bad conditions for placing, when it requires to increase the workability-time, etc.



UNE-EN 934(2) and (3)

Packaging: 1 l, 5 l, 25 l, 200 l

Consumption: 0,25 à 0,75 kg per cement bag

clais

dye for mortar and concrete



Clais is a powder product belonging to the chemical family of sulfonated aluminum and sodium silicates combined with crystalline particles, alkali and UV radiation resistant. Designed to color mortars or concretes with cement or lime binders. Incorporating Clais as coloring, does not decrease the strength feature of the mortar or concrete which is added.



It's used for architectural concretes, for concrete or mortar precast pieces, cobbles, pavements, facade mortars, mortars for grouting brick or stone (natural or synthetic), etc.

Packaging: S, M, and L, Depending on color.

Consumption: white cement 1 to 3% of cement weight, with grey cement 3 to 12% of cement weight.

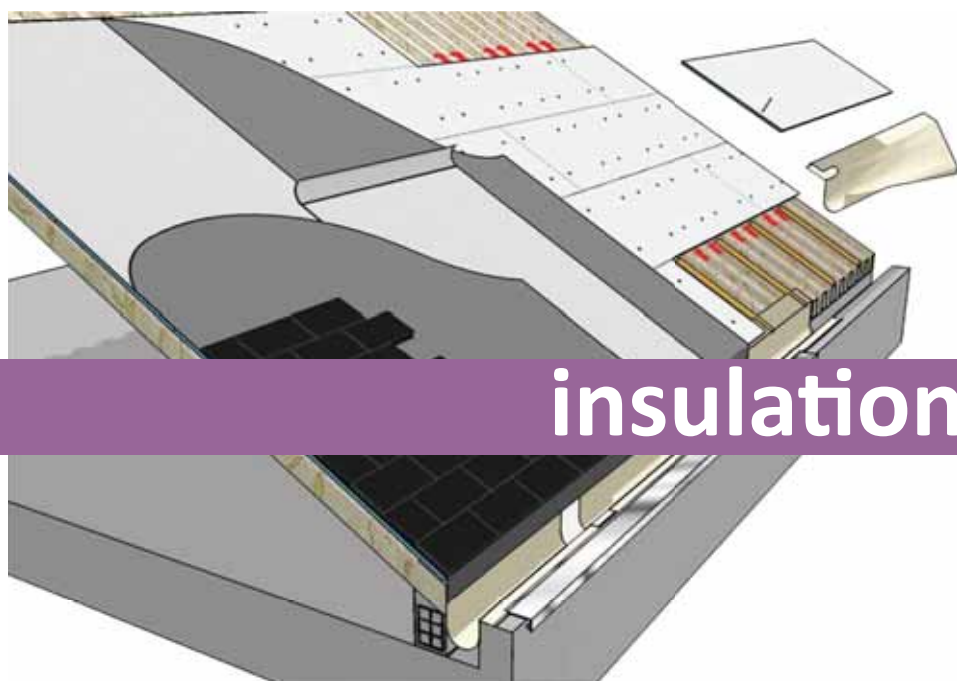
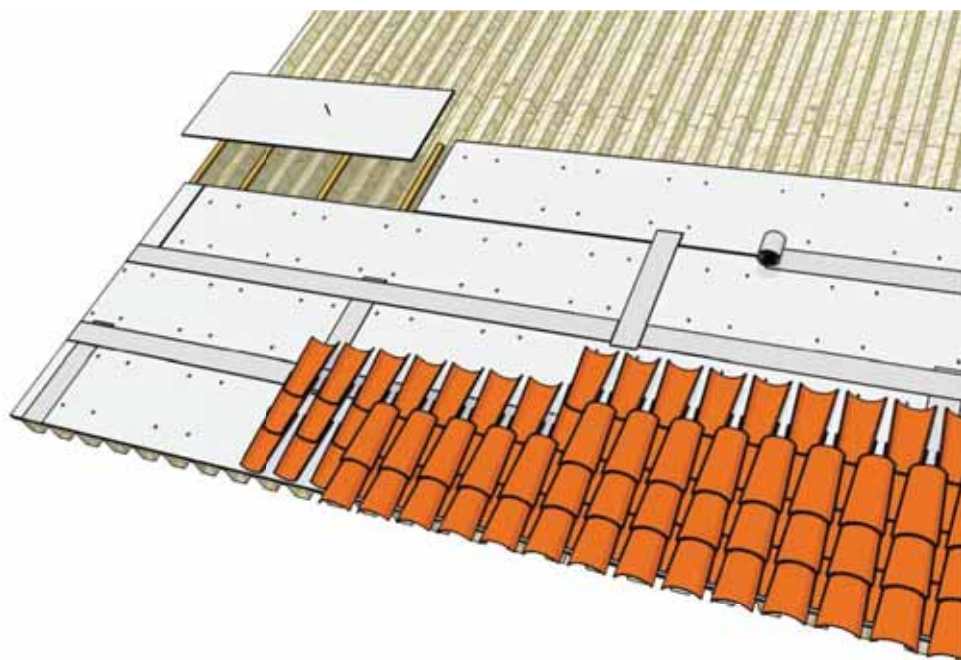

insulation

ACOUSTIC
climais

THERMAL
termoplak

FIBERS
fibra de polipropileno
fibrotais
teis fibracer

GLASS MAT
fibrais 150
fibrais 300

GEOTEXTILES
punzonais

STAPLES
grapais
teis grap dentada

FIBER MESH
tejaais
tejaais carbono

Learn more about our full range of products
www.teais.es

sound absorbing polyethylene membrane

climaïs

Climaïs is a sheet made of closed-cell extruded polyethylene to avoid noises from contact and impact through walls and slabs.

It is applied as acoustic insulate between walls and slabs, for radiant heating, for making smoother the slabs and as a barrier for the noise of impacts.

Packaging:

Roll of 180mx1,60mx3mm (288 sqm)

Roll of 200mx1,60mx2,5mm (320 sqm)

Consumption: 1,05 m2 per sqm



acoustic

polypropylene fibers for concrete and mortar

fibra polipropileno

Polypropylene fibers to used as an additive in concretes and mortars to provides them a decrease of retraction and cracks. The fiber is homogeneously added in mixture during the mixing.

It is used in mortars and concretes which the retraction must be controlled, to decrease the cracking and to improve mechanical resistance to impacts. It is used on industrial pavements, concrete-prefabs, renders, concrete slabs and concrete with impact resistance.

Packaging: 600g paper bag

Consumption: 600 g/cbm of concrete



fibers

fibrotais

short-yarns fiber to reinforce mortars and concretes



Fibrotais is a product which has yarns in fiberglass shape. It is used to reinforce plaster-renders, gypsum, cement mortars and concretes.

In the reinforcement of plaster-renders, concretes, etc. In areas that can be suffer mechanical bending efforts.



Packaging: Plastic bag of 50 g
Consumption: 50 g per 25kg cement bag

teais fibracer

steel fibers for making reinforced concrete

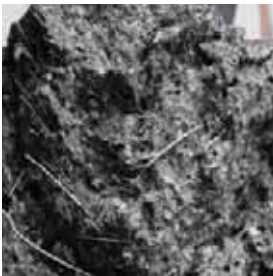

Teais Fibracer consist of steel fibers for making reinforced concretes on pavements and industrial paving

It's used as concrete reinforcement on industrial paving improving the load capacity, providing high mechanical resistances against bending and tensile, increases the resistance to impact and occasional efforts, non-structural replacing, easy to dose and the mixing can be done with usual tools.

In case of pavements is important to have vapour and humid barriers which avoid the capillarity moisture of indoor pavements mainly.



Packaging: 10 et 25 kg
Consumption: 20 to 40 kg/cbm

geotextile protection mat

punzonais

Punzonais is a product made in a geotextile way composed in base of 100% polyester non woven and joint by shoelaces and thermofusion.

Apply as separating layer of waterproofing systems on roofs and terraces keeping away the insulation from the punching caused by ground, sand, gravel, concrete mortar placing, etc. In drainage systems, on soils movements and foundations, in tunnels y canals, in erosion control, construction of reservoir and dams, etc

Packaging: Roll of 2x125 m
Consumption: 1,05 m2 per sqm



geotextiles

fiberglass mat for reinforcement

fibrais 150

Shaped product, obtained with threads of normal tiles, cut to a length of 50 mm bonded together by a binder emulsion, soluble styrene and compatible with polyester resins.

Fibrais-150 is a reinforcement designed to improve the mechanical properties of laminates and waterproofing based on polyester resin, elastomer resins, etc. Especially when dimensional and singular points needs stability.

Packaging: Roll of 1,25x60 m
Consumption: 1,05 m2 per sqm



glass mat

fibrais 300

fiberglass mat for reinforcement



Fibrais 300 is a shaped product, obtained with threads of normal titles, cut to a length of 50 mm bonded together by a binder emulsion, soluble styrene and compatible with polyester resins.

It is an reinforcement designed to improve the mechanical properties of laminates and waterproofing based on polyester resin, elastomer resins, etc. Especially when dimensional and singular points needs stability. Recommended for Lastois techumbres, Lastois cubiertas, Teais SK Film, etc.



Packaging: Roll of 1,25x122 m
Consumption: 1,05 m2 per sqm

tejiaais 5-150

mineral fiber mesh for reinforcement



Tejiaais 150 consists of a mineral fiberglass used for reinforcing cement based or acrylic mortars. TEJIAIS is resistant to the alkaline characteristic of cement based materials.

It is used as reinforcement in mortars, paints, cracks and fissures.

Specially designed for ETICS system, like our Teais Term System



Packaging: Roll of 50x1 m
Consumption: 1,05 m2 per sqm

galvanised and corrugated steel staples

grapais

Grapais consists of corrugated steel staples AEH-400N type of 200 to 300 mm length and diameter ranging from 4.5 to 6 mm.

These staples undergo galvanisation by electrolysis so as to prevent corrosion, with bending capacity at corners so as to adapt to different types of applications and are used for reinforcing and restoring.

It is used for blocking cracks on facades or walls. It is used for joining pieces, stone, concrete, etc. It is also used for overlapping sections.



Packaging: Blister of 5 ut, box of 60 and 300 ut.

Consumption: 3 ut/lm

staples

mesh based on carbon fiber for structural reinforcement

tejiáis carbono

Tejiáis Carbono is an unidirectional carbon fiber mesh used to reinforce concrete structures, brick walls and wooden structures.

The system consists of the mesh and a special epoxy adhesive type, Epoais Carbon.



Packaging: Roll of 30 lm x 50 cm

Consumption: Depending on use

fiber mesh

termoplak

thermal insulation boards for construction



Teais Termoplak is an ideal product for the restoration of terraces in a simple and economical way.

Teais Termoplak is a rigid panel with good resistance to mechanical compression and flexion, lightweight, thermal insulation and which allow numerous applications, for the renovation of fibro-cement terraces, allowing the subsequent installation of waterproofing or coating both synthetic and natural.

- *RESISTANT*
- *THERMAL INSULATION*
- *EASE OF USE*
- *VARIOUS THICKNESS*

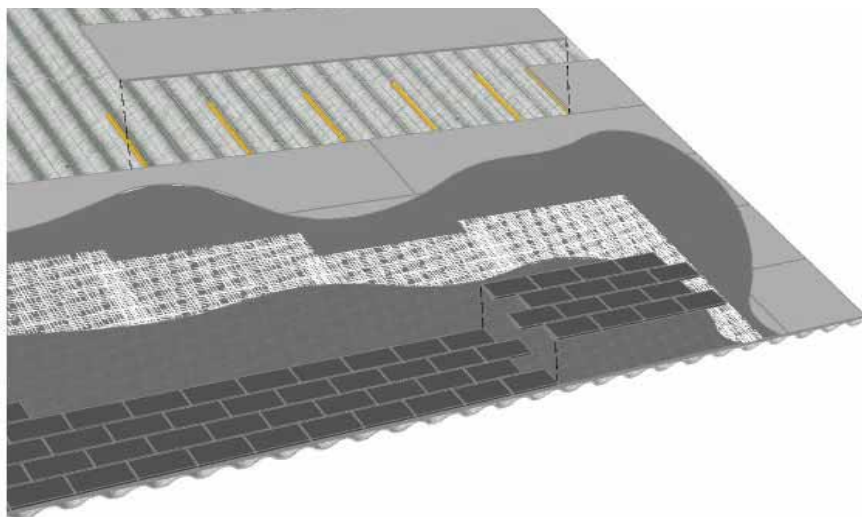
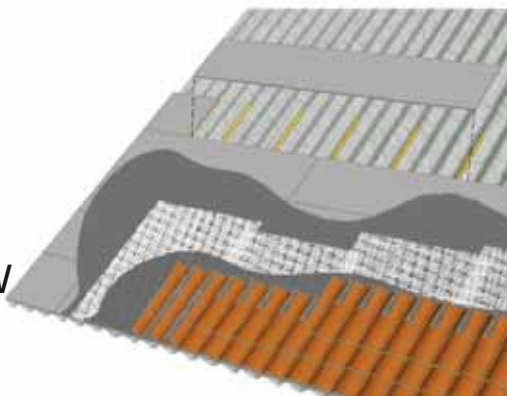

passive crack repair system with steel reinforcements

grapais

Grapais are corrugated steel staples AEH-400N 200mm long and 4.5mm diameter, electrolytically galvanized to prevent corrosion, bent at an angle according to different types of applications, reinforcement and rehabilitation.

They are used in the repair of passive cracks combined with an epoxy adhesive Bi-component and thixotropic and a repair mortar without shrinkage, as shown in the diagram.

For metallic reinforcement to be effective it must be placed at 3cm of depth of the surface.

Follow the course of the cracks, place it at 35cm approximately and of cross shape, realize with a grinder a hole of 7x22cm with a depth of the order of 4cm.

Apply a small amount of mortar without retraction and place the reinforcements alternately. Finish filling with the same mortar to the level of the surface.

The crack between the reinforcements must not be pitted, simply clean and seal with the appropriate material inside or outside.

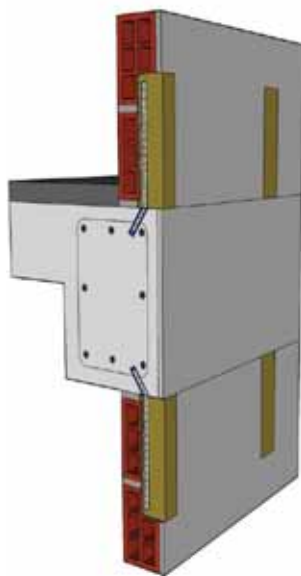

cracks



teais grap dentada

stainless toothed staple for crack blocking



Teais grap dentada, is a stainless toothed staple for crack blocking.

For repairing cracks on different surfaces.

In facades of facing bricks, facades of different types, on concrete floors or cracks, on the slabs, etc.

Teais grap dentada parts are stainless steel and have a special shape particularly ideal for various repairs.

The staples are placed with a special silicone Teais figrap, in vertical surfaces.

On horizontal concrete supports place with Epoais 3F. The separation between staples must be 15cm approx.

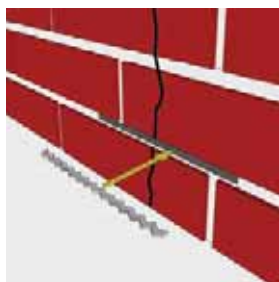

laying into the walls

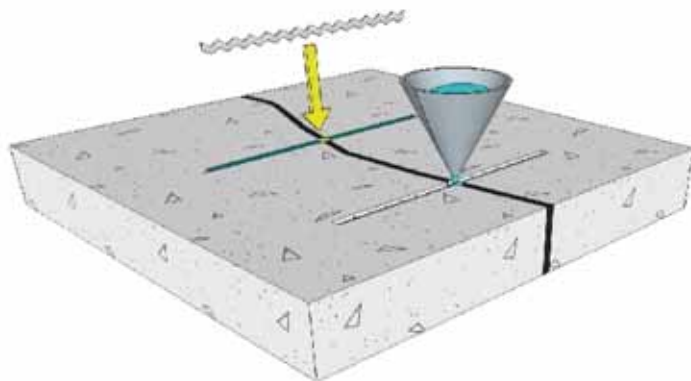

laying of teais grap dentada into the ground



FOR GUM-PLASTIC

*deais poly
despol
desmur*

FOR METALS

deais ecológico

FOR WOOD

deais mh

RETARDANT

*deais lava
deris
lais*

***Learn more about our full range of products
www.teais.es***

release agent for polystyrene mold plastic and gum

deais poly

Deais poly is a special mould release agent based on mineral substances, with high capacity of releasing that is no corrosive for plastic and rubber.

It is applied to obtain ornamental concretes which are made with moulds with several range of complexity, allowing an easily releasing maintaining the characteristics of the pieces.



for gum-plastic

Packaging: 5 l, 25 l

*Consumption: 10 to 20 sqm/l
according support and application*



powder product used as releasing agent for stamp concrete

despol

Despol consists of a powder product having special additives that make it ideal as releasing agent in stamped concrete flooring.

It is used as releasing agent in plastic moulds, avoiding the risk of breaking complex pieces upon turning them out.



for gum-plastic

Packaging: 10 Kg

Consumption: 5 sqm per kg



desmur

special product for moulds made of stamped one-coat mortar.



Desmur is a liquid product special for releasing of moulds made of rubber which are used in the texturized of one-coat mortar on facades.

The product is specially developed for application with one-coat mortar molds, gum molds in general of facades.



Packaging: 1 Lt, 5 l, 25 l

Consumption: 10 sqm/l

deais ecológico

ecological release-agent with vegetal base for universal use



Deais ecológico environmentally friendly vegetable-based release agent without solvents.

On industries dedicated to the manufacturing on prefab concrete and construction in general. It can be applied to all types of metallic molds, wood, plastic, polyester, elastomers, polystyrene, etc

Protect molds effectively and do not stick to concrete.



Packaging: 1 l, 5 l, 25 l, 200 l

*Consumption: 30 to 40 sqm/l
according to support and use*

special release agent for moulds made of wood and metal

deais mh

Deais mh it's an oily liquid specially formulated for moulds made of wood and metal.

It is used in all types of moulds made of wood or metal both in work and prefab industry. It can be used on concretes placed by traditional methods as vibrated, self-compacting, etc.



Packaging: 5 l, 25 l

Consumption: 5 to 10 sqm/l diluted

for wood and metal

surface setting retarder ragent for facing aggregate

deais lava

Deais lava it's a gelatinous liquid soluble in water, brown colour, made to increase the setting-time in the surface layers of mortars and concrete allowing an easy remove-form and superficial cleaning of concrete allowing to see the face side of aggregates.

To obtain a finish in the face side on aggregates, pavements, concrete prefabs, faced concrete, concretes in general where is required to obtain an effective support for further renders.

UNE-EN 934(2) and (3)

Great performance by its high concentration.



Packaging: 5 l, 22 l

Consumption: 3,5 to 5,5 sqm per l

release agent and retardant

deris

release agent and retarder in liquid shape



Deris is a special release agent with dual purpose: By one side, the release agent and for another side retardant that allow the faced aggregate finish with different particle-size.

There are three types of DERIS depending on the finish required: DERIS A (1-5 mm), DERIS B (4-7 mm), DERIS C (7-10MM).

It is used on pieces which are obtained by molding and want to be textured because its retardant effect the release agent avoids the setting of the concrete or mortar in contact with it what allows the releasing of the piece in order to obtain the desired texture.



Packaging: 4 l, 20 l

Consumption: 5 to 6 sqm/l

lais

superficial setting retarder for faced aggregate



Lais is a soluble liquid in water, of brown colour, made to produce a increasement of the setting-time in the surface layers of the mortars and concretes allowing a superficial cleaning on concrete and a face part of aggregates.

To obtain a faced aggregate-finished in decorative pavements or increases the superficial setting-time on concretes which a texture is required.



Packaging: 5 l, 25 l

Consumption: 3 sqm/l



plasters and special mortars



WATER PLUG

raís plug

PLASTERS

plastocal

emplascem

emplais interiores renovación

emplais exteriores

emplais interiores

MICRO-CONCRETE WITHOUT SHRINKAGE

hormifluis

hormigrout

hormitix

REFRACTORY MORTARS

refracmor

LAYING MORTARS

hormipavi fast

duroasfalt

REPAIRING MORTARS

moris

moris capa fina

teais alisador monocapas

moris inhibidor

teais baches

GROUTING MORTARS

morpi base cal

SELF-LEVELING MORTARS

morfluis

REHABILITATION MORTARS

rocamol prefabricados

rocamol rústico

QUICK SETTING MORTARS

teais recrecidos R35

cemraís

INDOOR SELF-LEVELING SCREED

panis

ANTI-CORROSIVE PASTE

protecor N

SPECIAL MORTARS

capilais

morsis recrecidos

Learn more about our full range of products

www.teais.es

ultra fast cement for water leaks sealing

rais plug

Rais Plug is an ultra fast setting cement that can seal water leaks immediately.

This product is used to seal water leaks in basements concrete walls , elevator pits, masonry, rocks, etc, as a previous treatment to waterproofing, allowing to the entry of water and making the subsequent waterproofing works with suitable products as Cepis or Cepis Super.



*Packaging: 5 kg, 20 kg
Consumption: According to use*

ultra fast cement

lime plaster, special for plastering

plastocal

Plastocal consists of a powder product.

When mixed with water, it forms an ideal paste used for plastering, smoothing and eliminating cracks and paint that comes off, both in interiors and exteriors, both on horizontal and vertical supports.

It is used to eliminate all kinds of irregularities so as to prepare supports before painting them, both in interiors and exteriors. It is appropriate for levelling of renders, for eliminating cracks and fissures on walls and ceilings.



*Packaging: 15 kg, 20 kg
Consumption: 1,5 kg/sqm in 1 mm layer*

plasters

emplascem

high adherence plaster for regularizing tile surfaces



Emplascem is a two-component product in powder and liquid shape which are made each other achieving a plaster with thixotropic consistency.

Is used for regularizing surfaces with bad adherence such as tile, brick, glazed, chipboard and several supports that want to be homogenized.

Surface preparation:

The support must be firm, free of greases, oils or any substance that may pollute the surface and well dry. Concretes and mortars must be cured at least for 28 days.



Application:

- Mix the liquid component manually or mechanically with the powder until obtaining a thixotropic paste with consistence.
- The mixture must be done manually or by a low-revolution electric mixer (300-500 rpm).
- Let the dough rest from 2 to 5 minutes before using.
- Apply with a stainless- stell trowel on the clean and dry support giving a thin first layer to cover all joints of the pieces.
- Let it dry and apply the finishing layer that can be sanded once it had hardened to remove smalls shapes made for the trowel.
- Let it dry before painting, wallpapering, etc.



- * High adherence
- * High thixotropy
- * Easy to apply
- * High Strength
- * Thin texture



Packaging: 12 kg, 25 kg

Consumption: 1,5 to 2 kg/sqm

powder plaster for indoor supports

**emplais
int. renovación**

Emplais interiores renovación is a solid powder product that when it is blended with water becomes in plastic paste suitable for filling, specially for damaged paints or gotelé painting eliminating cracks and flakings on walls and ceilings. Only for interiors.

To eliminate unevenness in the surfaces to paint on. Only for interiors. For levelling in renders. In the elimination of cracks.

In all works that requires a fast finish.

Packaging: 4 kg, 18 kg

Consumption: 1 kg/sqm in 1 mm layer



plasters

powder plaster for outdoor and swimming pools

**emplais
exteriores**

Emplais exteriores is a powder product based in cement to be mixed with water so as to form a plastic paste used for plastering, whitewash cracks and chippings on walls and ceilings, both indoor and outdoor.

Used so as to eliminate irregularities on surfaces to be painted afterwards (indoor and outdoor), to level rendered supports as well as to eliminate cracks and fissures.

Packaging: 1 kg, 4 kg, 20 kg

Consumption: 1,5 kg/sqm in 1 mm layer



plasters

emplais interiores

indoor plastering



Emplais is a powder product based in cement to be mixed with water so as to form a plastic paste used for plastering, whitewash cracks and chippings on walls and ceilings, for interior use.

It is used so as to eliminate irregularities on surfaces to be painted afterwards (in interiors), to level rendered supports as well as to eliminate cracks and fissures.



*Packaging: 1 kg, 4 kg, 18 kg
Consumption: 1 kg/sqm in 1 mm layer*

hormifluis

fluid micro-concrete without shrinkage



Hormifluis is a micro-concrete based on cement, very fluid, with compensated retraction and slightly expansive, particle-size structures from 0 to 2 mm that offers high mechanical resistances once hardened.

It is used for filling by pouring under support plates, filling of machine supports, bridge bearings and cranes, anchoring of metallic elements such as metallic supports, bolts, poles. Anchorings of concrete poles, pillars on precast construction, filling of cracks, cavities, etc.

The application thickness must be from 10 to 30 cm.



*Packaging: 25 kg
Consumption: 20 kg/sqm in 1mm layer*

fluid micro-concrete without shrinkage special for high strength work

hormigrout

Hormigrout is a micro-concrete of high resistance and great mechanical properties.

It is suitable for machines anchoring, levelling of machine platforms, support of bridges and cranes, filling by pouring under support plates, elements of metallic anchorages, filling of cracks and cavities into the concrete masses.

Allows application thicknesses up to 8 cm.



Packaging: 25 kg

Consumption: 2 kg/sqm in 1 mm layer

micro-concrete without retraction

thixotropic micro-concrete without shrinkage

hormitix

Hormitix is a micro-concrete based on cement, thixotropic and without retraction. Particle size from 0 to 3 mm. Once it becomes hardened offers high mechanical resistances.

In the reinforcement and reparation of micro-concrete structures. Damage reparation caused by movement.

Reinforcement and reparation on pavements areas made of concrete mainly in areas in no horizontal situation such as ramps, areas near to waterings, etc.

Apply it with thickness between 20 and 50 mm.



Packaging: 25 kg

Consumption: 2 kg/sqm in 1 mm layer

micro-concrete without retraction

refracmor

mortar directly resistant to high temperatures and fire



Refracmor is powder product which mixed with water and set, reduces heat transfer and resists direct fire, it's formulated based on refractory cement and specially selected arids.

In refractory bricklaying for lifting smokestacks, barbecues, ovens. For coating combustion chambers, boilers, smokestacks...etc.

Plasters in high temperature ambients.



Packaging: 5 kg, 25 kg
Consumption: 2 kg/sqm in 1mm layer

duroasfalt

micro-concrete for repair of agglomerate asphalt floors



Duroasfalt is a micro quick-drying concrete and adequate strength, consisting of cementitious binders, fibers, aggregates compensated grain, pigmented in black color.

It is used to make repairs on asphalt floors.



Packaging: 25 kg
Consumption: 20 kg/m² for each 1cm thickness

fast hardening mortar for road maintenance works

hormipavi fast

Hormipavi fast is a mortar based on cement, one-component and pre-dosed for fixing and support. It is made in dark colour in order to merge the asphaltic surface.

It is used for fixing manhole, concrete reparations, urban furniture anchoring, reparation of joints in roads and for fixing lights in the airports runways.



Packaging: 25 kg
Consumption: 2 kg/l



repair mortar

thixotropic mortar for reparation without shrinkage

moris

Moris is a thixotropic mortar without retraction, cement based, with selected arids, additives and fibers which, mixed with water becomes a restoration mortar suitable for many applications.

It's used on flakings, voids, cracks and blowholes repairs on concrete. Concrete surfaces regularization which requires good mechanical resistance and adhesion. Concrete repairs that have been broken by reinforcement corrosion. In wire anchorings, wood, profiled steel rails, etc. Protection of metal armors, concrete repairings, passive cracks sealing.



Packaging: 1 kg, 5 kg, 25 kg
Consumption: 20 kg/m² per 1cm thickness



repair mortar

moris capa fina

repairing mortar on thin layer



Moris special mortar for rehabilitating and repairing of concrete structures, based on special cements and great resistance and adherence bonders.

It is used for repairing of structures on thin layers, repairing and leveling of concrete structures, low thickness repairs, edges repairs, reprofiling of joints edges, etc



Packaging: 25 kg

Consumption: 1,8 kg/sqm in 1mm layer

teais alisador monocapa

special mortar for smoothing scratched one-coat mortar



Teais alisador monocapa is a mortar specially designed for smoothing one-layer mortar and can be painted on subsequently.

The main application is the smoothing and levelling of scraped one-layer mortar.



Packaging: 25 kg

Consumption: 1,8 kg/sqm in 1mm layer

repair mortar with incorporated corrosion inhibitor, no primer required

**moris
inhibidor**

Moris Inhibidor is a mortar based on cement, selected aggregates, special additives and corrosion inhibitor.

Ready to mix only with water.

It is used to repair concrete affected by corrosion on armours, in all types of structures, pillars, beams, balconies, tiles, slabs, etc.



Packaging: 25 kg

Consumption: 20 kg/sqm in 1cm thickness

pothole repairing over ground and screeds

**teais
baches**

Teais baches is a pothole repairing system both concrete pavements and natural floorings made of a cement-based binder with quite fluid consistence that can reinforce a filling of aggregates with particle size from 20 to 40 mm.

is used to make quick, firm and affordable fillings, on parking concrete floorings, paths, industrial areas, etc...



Packaging: 25 kg

Consumption: Gravel 18 kg/ltr, Mortar 14 kg/ltr

repair mortar

repair mortar

morpi base cal

laying and grouting lime mortar



Morpi base cal consists of a specially designed mortar used for laying and grouting purposes in masonry in general such as blocks, brick slips and stone. It is based on special conglomerants, selected aggregates, mineral fillers, additives amongst others.

It is used in masonry made of concrete blocks and brick slips. Also for waterproofing walls made of brick slips. It is used for joints in walls and facades made of stone



Packaging: 25 kg

Consumption: 10 to 15 kg per sqm of wall

morfluis

self-leveling screed



Morfluis is a powder product based on cement that contains several additives which provides to it special properties for making self-leveling screeds on pavements until 30mm.

The product is ideal for regularization screeds both indoors and outdoors.



Packaging: 25 kg

Consumption: 1,8 kg/sqm per mm of thickness

crushed rock with rustic finishing for natural stone refurbishment

**rocamol
rústico**

Rocamol Rústico is a product based on crushed rock, cement, lime, additives, colourings that is used to covering imitating natural stone with rustic texture and also to imitate stone in construction refurbishment.

It is used for imitating texture and colour in existing stone that require refurbishment or to render single coat, combined or complementary.



restoration mortars

Packaging: 25 kg

Consumption: 18 to 20 kg/sqm in 10 mm layer



crushed rock for the realization of precast imitation of natural stone

**rocamol
prefabricados**

Rocamol Prefabricados is a product based on crushed rock, cement, lime, additives, colourings used to make prefab or molded pieces.

It is used to the realisation of ornamental pieces, moulds replacement and recovering, sculpture, etc... Both new building and refurbishment.



restoration mortars

Packaging: 65 kg

Consumption: 1,8 à 2,0 kg/l of volume to be filled



teis recrecidos R35

special cement for screeds



Teais Recreidos R35 is used for made concrete floors and screeds which requires a fast commissioning.

Powdered and mixed with Arcuais in the following proportions: 1: 4 or 1: 5

The product has a high yield because it mixes with an agglomerate.



Packaging: 25 kg

Consumption: According to the mixtures

cemrais

quick setting mortar



Cemrais is a product presented as a fast setting cement which mixed with water is used as instant seal, plasting waterways from cracks, fissures or openings formed on concretes and other cement and rigid supports.

Clog concrete pipes instantly. Reassemble broken pipes (even under load), repair water pipes, galleries and basements, gas leaks, seal concrete slabs, water tanks, swimming pools, make small repairs in manholes or water pipes that have to be put into service quickly.



It is not suitable for clogging waterways.
For this application we recommend Rais.

Packaging: 5 kg, 20 kg, 22 kg

Consumption: 2 kg/m² in 1 mm layer

self-leveling screed for indoor slabs to be coated

panis

Panis is a powder product, which mixed with water, becomes a self-leveling screed, specially made to regulate the floor surface area, leaving them smooth, with an appropriated planimetry to receive multiple coatings.

It is used for pavement levelings, in thin and medium layer, onto open pore holders like non-polished mortar and concrete. Training support plane for the placement of floor coverings such as ceramic tiles, stoneware tiles, marbles, natural stones, carpets, parquet, synthetic floors, etc.

Packaging: 4 kg, 25 kg

Consumption: 1,5 kg/m² in 1 mm layer



self-leveling screeds

protective coating and adhesion for concrete reinforcement rust

teis
protecor N

Teais Protecor N is a two component product based on special microtextured resins and additivated with corrosion inhibitors.

It is used as a protective layer for reinforcements in structure repair works, and provides an adequate adhesion layer over concrete and armor before applying repair mortars (Moris, Homifluis, Hormitix, etc..)



Packaging: 1.5 kg, 8 kg

Consumption: 0,3 to 0,4 l/sqm

anti-corrosion

morsis recrecidos

special mortar for regularization layers on slabs



Morsis recrecidos is a mortar based on cement and quartz aggregates with a compensated particle-size. High workability and thixotropy.

It is used for the realization of regularization layers both in horizontal planes and inclined. On concrete floors which requires a regularization, on waterproofing systems as a protection on terraces or decks. It can stand as a finish doing the necessary contraction joints or be cladded with slabs.

Can remain as a finish by making the necessary contraction joints, or be clad in tiles.



Packaging: 25 kg

Consumption: 2 kg/sqm in 1 mm layer

capilais N

mortar contributing to the cleaning of moisture by capillarity

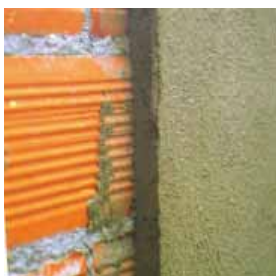

Capilais consists of a specially designed mortar used to clean facades and walls that are affected by rising dampness, both in interiors and exteriors.

By its characteristics it promotes the evaporation of the moisture of the facing and its transpirability.

Ideal for application in addition to our capillary injected capillary blocking system, Teais Capi C.



Packaging: 25 kg

Consumption: 20 kg/sqm in 20 mm layer



cleaners

FUNGICIDES

lipis

saneante de moho

TOOLS

disolvente de limpieza

OILS AND FATS

desincrustois

DETERGENT CLEANERS

teais cleaner

teais deter

teais lim-ps

WOOD CLEANERS

teais nutrimad

CEMENT REMAINS

coais super

coais super gel

SALTS

limsal

OXYDES

lioxis

Learn more about our complete line of products
www.teais.es

microorganism and pollutants cleaner

lipis

Lipis is a concentrated liquid product formulated for cleaning and removing microorganism, dirty and wastes on stones, face brickwork facades, composites and others. Translucent appearance and soluble in water.

It is used for cleaning on natural and artificial stone, composites, concrete, face brick, fibrocement, floor tiles, small tiles, gres tiles, renders, cement mortars, wood, etc. For cleaning polluted walls having mould or fungus.

Apply in one coating and rub with a brush, if necessary, when cleaning. Then clean and apply SANIS so as to eliminate any possible penetrating fungus.

Packaging: 1 l, 5 l, 25 l

Consumption: 5 sqm/l



fungicides

liquid for mould removal for walls and ceilings

saneante de moho

Saneante de moho high concentrated liquid with high performance to clean, made for absorbent surfaces and to clean them up removing pollution caused by moss and algae.

It is used on polluted surfaces contaminated by concrete, natural and artificial stone, faced brick, mortar rough coating, tiles, fibercement, etc.

Very suitable for cleaning contaminated supports by moss in bath areas, kitchens, windows perimeter, areas of thermic bonding agents, against pillars or beams. As a previous treatment in cleaning up before painting.

Packaging: 1 l, 5 l, 25 l

Consumption: 5 to 7 sqm/l

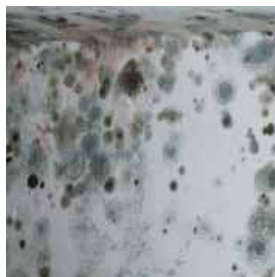

fungicides

disolvente de limpieza

solvent for cleaning



Solvent specially formulated for cleaning tools and machinery.

Not suitable for diluting paints and varnishes.

It is mainly used for cleaning and maintenance.



Packaging: 0,75 l, 5 l, 20 l

Consumption: depending on use

desincrustois

mineral grease, asphalt and oils remover



***Desincrustois** is a cleaner agent product for asphalts, tars and very embedded greases based on solvents. It is powered with emulsifying agents. This is the reason because results a liquid with high dispersion performance which is able to remove the most difficult spots.*

Used for cleaning on concrete floors on workshops, factories, garages, parkings (affected by polluting fluids).

For cleaning embeddings of tar grease, oil, asphalt, etc



Packaging: 0,75 l, 5 l, 20 l

Consumption: 3 to 5 sqm/l

concentrate neutral detergent

**teais
cleaner**

Teais Cleaner is a neutral detergent with high concentration that cleans without damaging the materials.

Suitable for cleaning floors and coverings. Suitable for cleaning floors made of natural stone with a polished finish.

Porcelain stoneware, ceramic and glazed stoneware, extruded stoneware, cement, wood, plastic sheets, linoleum, rubber and PVC, etc. TEAIS CLEANER is a cleaner suitable for maintenance.

*Packaging: 1 l, 5 l
Consumption: 50 to 1500 sqm depending on dilution*



acid-based scrubbing detergent and surfactants

teais deter

Teais Deter is an high performance acid descaling detergent agent.

It is used for removing polish from works of coverings placement. Removes saltpeter and efflorescence, calcareous incrustations. It cleans and descaling at the same time and removes rust spots. It can be used on ceramic supports, glazed stoneware, porcelain, mud, natural stone resistant to acid. TEAIS DETER is suitable for cleaning in works.

*Packaging: 1 l, 5 l, 20 l
Consumption: diluted in water 1:5 until 1:10
de 10 à 40 sqm/l*



teis lim-ps

special cleaner for solar panels and glass



Teais lim-ps is a cleaning product specially formulated based on surface-active and volatile compounds for cleaning and maintenance on solar panels and glasses

It is used for cleaning surfaces on solar panels, removing easily as dust as dirty remaining on the panels (bird droppings, small insects, etc).

For cleaning and maintenance on glass surfaces.



Packaging: 1 l, 5 l

Consumption: depending on use

teis nutrimad

soapy professional concentrated cleaner for wood



Teais nutrimad is formulated based on non-ionic surfactants, high quality nutrient oils, and additives that dilute dirt without leaving any trace on wood.

For the cleaning and maintenance of floors and several types of wood surfaces (Neither apply onto fine woods nor onto wooden surfaces without protection). TEAIS NUTRIMAD because its special formulation with high quality oils, provide the best quality on wood maintenance.



TEAIS NUTRIMAD is also an excellent cleaner for TEAIS MICROCEMENTO and all types of smooth finish mortar

Packaging: 0,75 l, 5 l

Consumption: 20 to 60 cc into 10 l of water

very active cleaner for cement residues and oxides based on acids and surfactants

**coais
super**

Coais Super is a cleaner agent with high concentration formulated from the combination of acids and surfactants that has the property of diluting and removing the wastes made of cement, concrete, lime, mortar and rust on floors, walls, etc.

For cleaning floors, faced brick walls, timber formwork, spot cleaning of rust on stone, cement and lime wastes etc. For the application is required to do a previous test that verifies the suitability of the product.

Packaging: 1 l, 5 l, 25 l

Consumption: 10 to 15 sqm/l



cement remains

chemical super cleaner agent in gel consistency.

**coais
super gel**

Coais Super Gel is a super cleaner agent specially formulated in base on substances of acid nature, surfactant and additives, as rust inhibitors that allows a better wetting, penetration and removal of the areas to clean.

Very suitable for cleaning work wastes, cements, lime, rust and salts both in vertical and horizontal supports.

It is used in slabs, ceramics, gres, natural stone, pools, facades, fountains, terraces, formworks, work machinery and metals.

Packaging: 1 l, 5 l, 25 l

Consumption: 10 to 15 sqm/l



cement remains

lioxis

gel cleaner of oxides



Lioxis is a concentrated liquid that applied on rusted surfaces removes the rust and passivates the substrate of the corrosion having time to protect with the most suitable primer.

In the cleaning and passivation of rust on old metallic surfaces. As an anticorrosive base of primer.



*Packaging: 1 l, 5 l, 25 l
Consumption: 5 to 7 sqm/l*

limsal

surface salts cleaner



Limsal is a liquid product specially designed for cleaning superficial salts in several supports in construction. LIMSAL forms a thin coat that softens and attack salts removing them.

Limsal is used on several supports in construction where is required to remove the superficial salts incrustations, facades, stone walls, faced brick facades, mortars without cover and mortars with finishes in stone, etc



*Packaging: 1 l, 5 l, 25 l
Consumption: 5 to 7 sqm/l*



waterproofing



CAPILLARITY

lastosalis
teis barrera capilar
teis Capi-C

FOR TERRACES

lastois ms líquido
teis sk film
lastois techumbres
lastois fibro

WATER REPELLENT

repais
repais hidroconsolidante
repais antiverdín
repais efecto memoria
teis idrof

FOR TERRACES

lastoflex-oc

FOR FACADES

lastois fhcv
lastois capa intermedia
lastois flex

PROTECTION

lastois RS

FOR FLOORS

teis antiverdín seguridad

FOR GUTTER

lastois canalones

FOR STONES

propi

WALKABLE

lastois ip

OF CEMENT

cepis
teis impercem

OTHER USES

cubierta jardín
teis ferroprotec inyección

Learn more about our full range of products
www.teais.es

paint against moisture

lastosalis

Lastosalis is a very suitable product for the application on supports with high alkalinity which want to be painted on and for protecting paint. Also in slight rising-damp before the application of other paints and when integral waterproofing works are not to be done. For avoiding spots by moisture. Avoid efflorescences.

The support is also suitable for repainting on supports where mortars have less than 28 days of drying, it avoids the stain and bubbles formed on the paint by alkalinity.

Packaging: 0,75 l, 4 l, 20 l
Consumption: 3 to 4 sqm/l



capillarity

mortar for capilarity barrier formation

teais barrera capilar

Teais Barrera Capilar is a mortar in base of epoxi-cement resins, high adherence, waterproof and vapour barrier. TEAIS BARRERA CAPILAR is a three-component mortar, with easy application and with excellent work performance.

It is used to cut the capillarity in the assembly of walls and walls. It has the advantage over conventional waterproofing not to cut the continuity of facing because besides being an excellent waterproofing, it is highly adhesive and thus allows to perfectly join the wall.

Packaging: 24 kg
Consumption: 2 kg/ml per 10 cm of width and 1 cm of thickness



capillarity

teais capi-c

injecting system used to protect against rising dampness



Teias Capi-C is a system that consists of injectors so as to protect against rising dampness. It is based on special resins with great damp-proof and waterproofing power. Its great fluidity ensures excellent penetration into the pores until reaching the point of saturation.

it is used to create a blocking effect so as to protect against rising dampness in wall made of different materials such as stobe, hollow brick, sold brick, etc.



Packaging: 0,4 l

Consumption: 1 injector of 400 cc every 15 cm aprox according to the thickness of the wall

lastois ms liquido

ms liquid polymer waterproofing agent

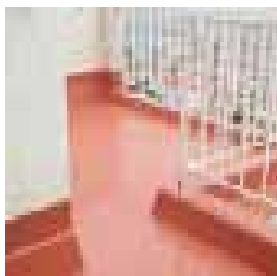

Lastois MS Líquido is a MS polymer-based waterproofing, which has very good waterproof properties on various support types and also on a wet surface. The product has a fast drying.

It is used for waterproofing decks, terraces, chimneys, deck edges, singular points, etc. Vertical and horizontal surfaces. It is able to stick on concrete, mortar, zinc, fiberglass, tiles, bricks, steel and aluminium.

Mainly for work requiring fast commissioning and execution.



Packaging: 4 l

Consumption: 1,5 to 2,5 kg/sqm depending on use

waterproofing roof

teais
sk film

Teais SK Film is a waterproofing covering with viscous consistency based on copolymers of styrene-acrylics in watery emulsion that once it is dry forms a flexible film, waterproofing and durable.

It is used in waterproofings of roof, crossable roofs on several supports such as tiles, fibercement, zinc, aluminium, wood, tiles, bricks, mortars, bitumen sheets finished in mineral grain or in aluminium, vertical walls, polyurethane foam protection, etc.

*Packaging: 5 kg, 20 kg
Consumption: 2,0 kg/sqm*



terraces

high performance elastomeric waterproofing for roofs

lastois
techumbres

Lastois Techumbres is an elastic waterproofing of viscous consistency based on a styrene-acrylic copolymer in aqueous emulsion, which is applied as a paint and, once dry, forms an elastic, flexible membrane of high adhesion and longevity.

The product is used to waterproof the roofs, accessible and not accessible. Also for waterproofing of terraces, roofs, roofs, balconies, gutters etc. Protection of adjoining walls, chimney treatments, inclined windows on terraces, etc.

*Packaging: 1 kg, 5 kg, 20 kg
Consumption: 2 kg/sqm*



terraces

lastois fibro

elastic waterproofing with embedded fibers



Lastois fibro is a waterproofing based on styrene acrylic resin, presenting thixotropic consistency and incorporating special fibers. Specially developed for getting durable flexible waterproof membranes.

Suitable for waterproofing decks with a low visitor transit. It can be applied on various substrates such as mortar, concrete, tiles, bricks, wood, aluminum, zinc, cement, polyurethane foam, tiles, asphalt sheets with aluminum or slate termination, dividing walls, roofs and singular points, etc.



Packaging: 1 kg, 5 kg, 20 kg
Consumption: 2 kg/sqm

repais

water-repellent transparent liquid



Repais is a resin based on low molecularity siloxano-oligomer, that facilitates penetration in the interior of the holder without leaving any waste or gloss in the surface, providing it from water-repellent properties, without inhibiting material breathability and without allowing dissolution of soluble salts, acting as an integral water-repellent. Suitable mainly for stone supports or unglazed ceramic.



Protection against water, frost and pollution in brick facades, marble, granite, roof tiles, unglazed ceramic, etc. Protects materials from water penetration and growth of external agents produced by the moisture. Improves facades resistance to the passage of water. Reduces dust penetration. It's breathable.

Packaging: 1 l, 5 l, 20 l
Consumption: 6 sqm/l

hardener and water-repellent for stone

**repais
hidroconsolidante**

Repais hidroconsolidante is a product based on compounds of siloxanes, silanes and silicates in solution.

It is a double treatment. It has consolidating effects and water-repellent as well because is very suitable to apply it to mineral supports and stones which require to harden and water-repellence.



Packaging: 0,75 l, 5 l, 20 l
Consumption: 5 sqm/l

water repellent

water-repellent with extended effect

**repais
efecto memoria**

Repais efecto memoria is a resin in base of oligomer siloxanes with nanoparticles with fractionated release. This innovation in the product formulation causes that part of the active effect endures over time. Thus when the maintenance is done one part of the effect is always active.

It is used as a colourless water-repellent treatment on surfaces of mortar, faced brick, faced concrete, natural and artificial stone, marble, granite and tiles.



Packaging: 1 l, 5 l, 20 l
Consumption: 6 sqm/l

water repellent

repais antiverdín

water-repellent with anti-moss effect



Repais antiverdín is a resin based on low-molecular weight oligomer siloxane that makes easier its penetration within the support avoiding waste and brightness on the surface, achieving its water-repellence, allowing the material transpiration and avoiding the dilution in soluble salts being as an integral water-repellent at the same time that protects against the formation of vegetation where the product is applied on. Mainly suitable for supports made of stone and non-glazed ceramic.

For facades of bricks, concrete, marble, granite, tile, slate, etc.



Packaging: 1 l, 5 l, 20 l
Consumption: 6 sqm/l

teais idrof

waterproofing for outdoor floors



Teais Idrof is a colourless liquid based on special resins with high penetration capacity.

It is used for protecting passable floorings of terraces, decks, etc, decreasing the absorption and filtrations produced by the porosity of the materials.

It can be applied on supports made of ceramic, gres, natural stone, clay, both terraces and decks.



Packaging: 1 l, 5 l, 20 l
Consumption: 8 to 10 sqm/l depending on absorption

super-elastic waterproofing agent based on polymerized rubber

**lastoflex
OC**

Lastoflex OC is a polymerised natural rubber waterproofing agent which forms a continuous, high adhesion, good aging strength, high tensile strength and elasticity membrane. Must be armed with Veloais 50.

For waterproofing of terraces, balconies, gardens, cementitious waterproofing, protection of concret against light aggressions, as a vapor barrier wher it's necessary, etc.

Waterproofing which requires later protection.
Can be applied on a slightly moist surface.

Packaging: 4 l, 16 l
Consumption: 2 kg/sqm



for terraces

waterproofing coating based on elastomeric resins

**lastois
fh-cv**

Lastois fhcv is a one component product, elastomer and plastic resin based with additives and high water-resistant pigments. It is used as external waterproofing covering.

It is ideal for waterproofing and decorating in facades. In certain cases, it also used for waterproofing on passable decks. It is also applied as finishing coat for LASTOIS CAPA INTERMEDIA.

Ideal for façades in marine environments, harsh climates, tropical areas, coastal areas, etc.

Packaging: 5 kg, 20 kg
Consumption: 1,8 m/kg



facades

lastois capa intermedia

elastomeric waterproofing base layer of lastois systems



Lastois capa intermedia is a product based on elastomeric resins, additives and pigments with high resistance to water properties. It is easy to apply because is one-component. Efficient as a waterproofing.

For waterproofing decks, facades and exterior walls in general. As base layer for further finishing with LASTOIS FH-CV in waterproofing systems with medium and high requirements.



Packaging: 5 kg, 20 kg
Consumption: 1,5 to 2 kg/sqm

lastoisflex

flexible layer of high adhesion for the regularization of surfaces

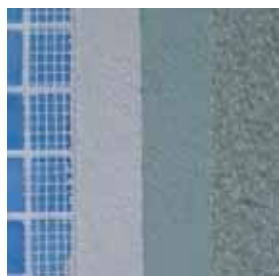

Lastoisflex is a product based on elastomer resins, selected charges, polymers and additives that is in paste shape and ready to use.

It is used for levelling porous or glazed supports on facades such as glass, ceramic, monolayer, mortars based on cement or lime, etc. LASTOIS FLEX has high adherence to support so primers are not required.



Lastoisflex has a high adhesion and does not require any primer on the substrate. It retains its flexibility once hardened.

Packaging: 15 kg
Consumption: 3 to 5 kg/sqm

elastomer-based waterproofing reinforcements

lastois RS

Lastois RS is a liquid product based on water-stable copolymers which is used as a protection for elastomeric waterproofing membranes such as Lastois techumbres, Lastois cubiertas, Lastois FH-CV, Teais SK Film.

The product reduces traces of water on membranes.



Packaging: 5 l, 20 l
Consumption: 5 sqm/l

protection

anti-mold treatment for exterior floors

teais
antiverdín seguridad

Teais antiverdín seguridad is a product based on special resins, siloxanes and surfacing protectors that avoid the development of microorganisms.

It is applied on floor areas where the development of moss can be possible avoiding the risk of fall. The most suitable applications are: in sidewalks, ramps, walkways, patio, stairs, terraces, balconies, rain gutters, facades, roofs.



Packaging: 0,75 l, 5 l, 20 l
Consumption: 5 to 6 sqm/l

floors

lastois canalones

special waterproofing for gutters



Lastois canalones is a product based on bicomponent resins and consistencies gel type, with great adhesion and elasticity ideal for the waterproofing of gutters.

Ideal for waterproofing of gutters of concrete, sheets, PVC (after sanding).

A fiberglass sheet should be used to provide continuity and facilitate the application of vertical fibers.



*Packaging: 8 l
Consumption: 2 kg/sqm*

propi

stone waterproofing



Propi is a varnish based on resins conveyed in solvents of high adhesions and resistances, compatible on mineral supports such as stone.

Reduces the risk of staining, gives a wet appearance and promotes cleaning, protects the work of certain substances, revives and enhances the areas to which it applies.



*Packaging: 0.75 l, 5 l, 20 l
Consumption: 4 to 6 sqm/l*

waterproofing and floor at the same time

lastois ip

Lastois IP is a bi-component product formulated with moderate epoxy resins of high adhesion and elasticity that must be mixed at the time of use.

It is used as a waterproofing agent and floor at the same time, in the roofs plaster, without needing after protection.

Lastois IP offers the best resistance and adhesion in walkable waterproofing systems, avoids having to remove on an existing waterproof layer.

To prevent color alteration it is necessary to protect with Poliuretano 80/20.

Packaging: 1 kg, 10 kg

Consumption: 2 kg/sqm



walkable

cement-based waterproofing mortar

cepis

Cepis is a powdered product based on cement and special additives and selected aggregates of controlled particle size.

Used for waterproofing basements and elevator cages from the inside. For the protection of concrete structures against freeze-thaw cycles.

As a filler coating of cement supports, cinder blocks, concrete blocks, sealing small cracks without movement on concrete structures, tunnels, channels, and structures in general that contain water, such as gutters And concrete planters.

Packaging: 5 kg, 25 kg

Consumption: 2 to 4 kg/sqm, depending on application



of cement

teais impercem

two-component elastic waterproofing

Teais Impercem is a two component waterproofing product that consists of cement, special aggregates, additives and synthetic polymers in water scattering.

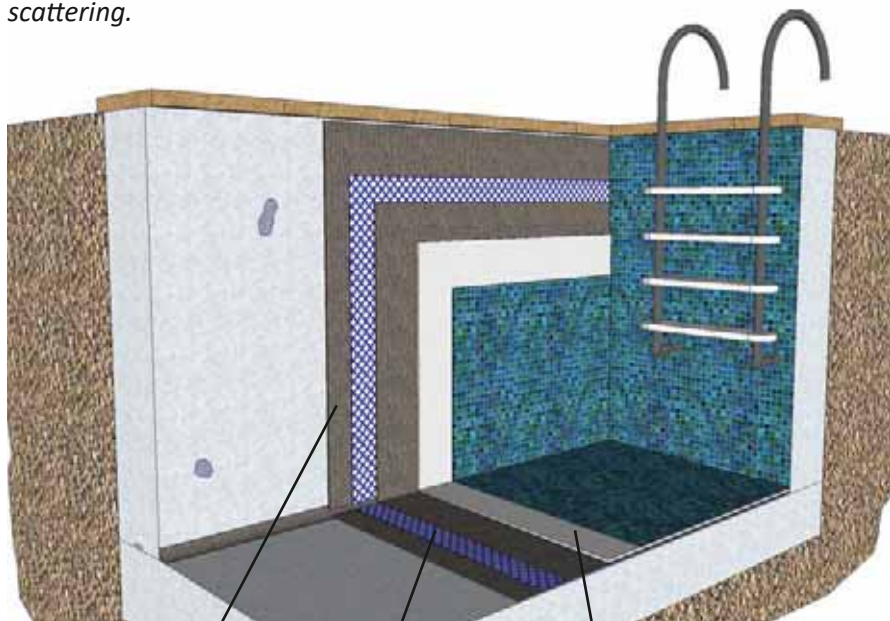

teais impercem tejais 5-150 cecois piscinas

The product applies to concrete walls, small decks, balconies, showers, waterproofing for concrete surfaces subject to external stresses such as de-icing salts, environments in the presence of sulphates, chlorides, waterproofing Swimming pools. Also used as ceramic adhesive, for mosaics in bathrooms and swimming pools, for fixing shower tray, etc.



Packaging: 15 kg, 75 kg

Consumption: 3 to 4 kg/sqm

injectors for capillary moisture based on water-repellent and waterproofing resins

**teais
capi-c**

capillarity

Moisture by capillarity is a pathology of the construction, produced by a phenomenon of capillary ascension of the water through the porosity of the materials.

Moisture from capillary action manifests itself in stains, paint blisters, fissures of the coating, at a height of not more than one meter from the ground and parallel to it.

Moisture wicking spots do not disappear and this type of moisture can be resolved favorably when it achieves a horizontal barrier that prevents the rise of moisture.



Teais Capi C is an injection system that is placed in the walls affected by moisture by capillarity. The system consists of making perforations with a drill in the wall or should be placed the injectors. The injected liquid has a high penetration and cures in a moist environment forming a barrier that prevents the access of the capillarity in the facing. The system allows repairs in the walls of stone, concrete, hollow and massive brick.



- **HIGH PENETRATING POWER**
- **HIGH FLUIDITY**
- **EXCELLENT BLOCKING PROPERTIES**
- **POLYMERIZED IN WET ENVIRONMENTS**
- **RESISTANT TO ALKALINE COMPOUNDS**

Packaging: 0,4 l

*Consumption: 1 injector of 400 cc /15 cm aprox.
depending on thickness of the wall*

cubierta jardín

*vegetated roofing system
for its installation as well on new
as for a restoration*

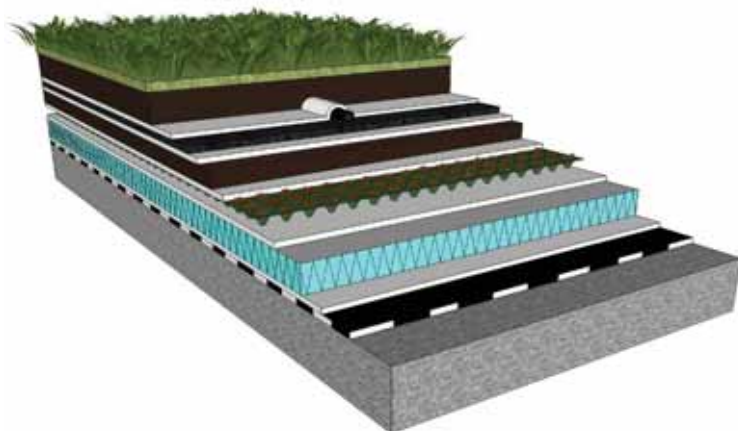

***Teais cubierta jardín** is a covered area for laying vegetation with significant advantages:*

- *IMPROVES ACOUSTIC INSULATION*
- *IMPROVES THERMAL INSULATION.*
- *ENERGY SAVING.*

Improved urban life by contributing to the reduction of environmental contamination and flood risks.



This system is based on an extensive low maintenance roof system because it requires a simple check every 6 months.

It is also possible to install an intensive system with vegetation that requires a higher type of vegetation and maintenance and an increase in the substrate layer.

injections for blocking capillarity and inhibition of corrosion

**t. ferroprotec
inyección**

capillarity

Teais ferroprotec inyección, is a liquid product that stops upward moisture by capillary action on reinforced concrete structures and simultaneously inhibits the corrosion of reinforcements on the treated areas.

The product is available in individual packages that allow localized injections.

For laying injectors achieve a perforation with a drill 12 mm, 1/3 deep on the side of the column; In the area to be treated.

The perforation is done in the downward direction (45°) and place the injector and let it empty. Finally, reseal the perforations with Epois 3F.

Repairs to the area to be treated may be carried out prior to injection. Remove the deteriorated concrete, clean the frame and apply Moris Inhibidor.



1. Perforation à réaliser en cas de saturation importante d'humidité



- HIGH PENETRATION CAPACITY
- HIGH FLOW
- GOOD SHUTTER PROPERTIES
- POLYMERIZED IN WETLAND
- EXTENDS THE LIFE OF THE STRUCTURE
- BARRIER AGAINST HAIR MOISTURE
- RESISTANT TO SULPHATES AND ALKALINE COMPOUNDS

Packaging: 0,4 l

Consumption: 1 injector of 400 cc per 15cm approx. depending on thickness of the wall

For walkable terraces

Lastois IP

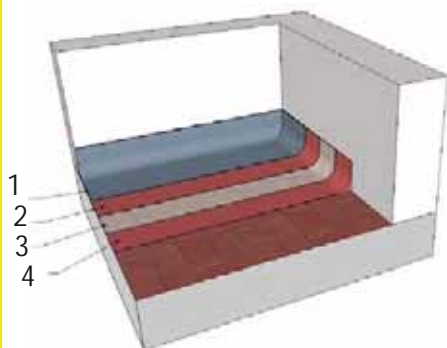

1. poliuretano 80/20
2. lastois ip
3. fibrais 150
4. lastois ip

Lastois IP + durepox auto.

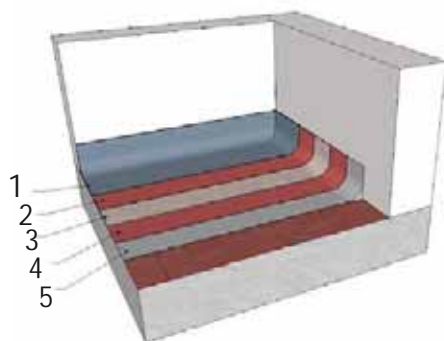

1. poliuretano 80/20
2. lastois ip
3. fibrais 150
4. lastois ip
5. durepox autonivelante

Lastois Transi PU

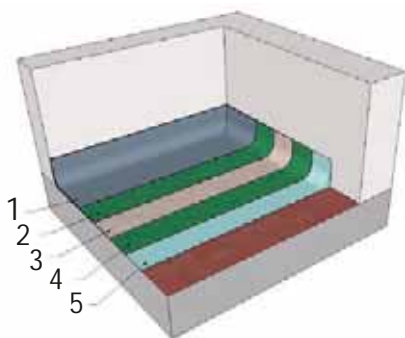

1. poliuretano 80/20
2. lastois transi PU
3. fibrais 150
4. lastois transi PU
5. impridur

Lastois transi PU+ durepox

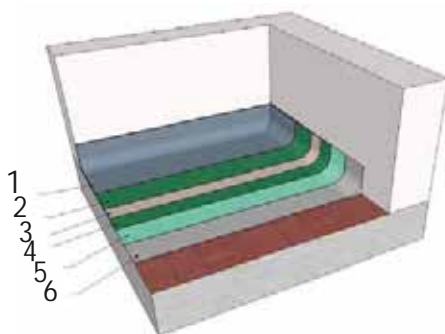

1. poliuretano 80/20
2. lastois transi PU
3. fibrais 150
4. lastois transi PU
5. impridur
6. durepox autonivelante

For walkable terraces with tiled finish

Teais Impercem

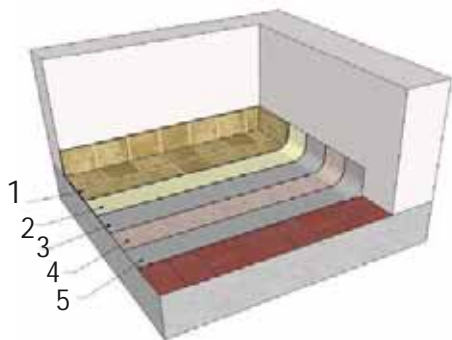

1. slab
2. cecoisflex
3. teais impercem
4. tejaiais 5
5. teais impercem

Lastois Imper PU

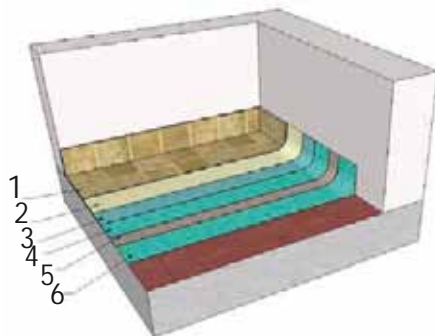

1. slab
2. cecoisflex
3. sembrado arcuais
4. lastois imper PU
5. fibrais 150
6. lastois imper PU

For finishing of non walkable terraces

Lastois Techumbres + durepox

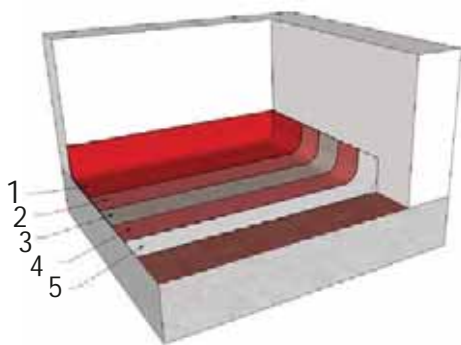

1. lastois RS
2. lastois techumbres
3. fibrais 150
4. lastois techumbres
5. durepox autonivelante

Lastois Techumbres

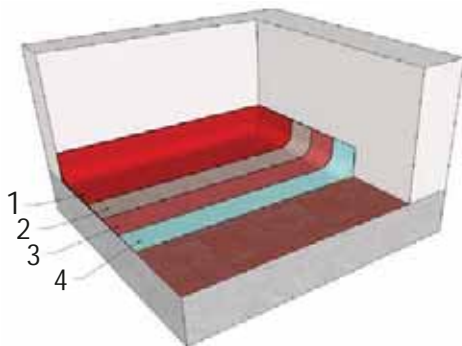

1. lastois techumbres
2. fibrais 150
3. lastois techumbres
4. imprimaís MU

For moderate walkable terraces

Imper-transi PU system

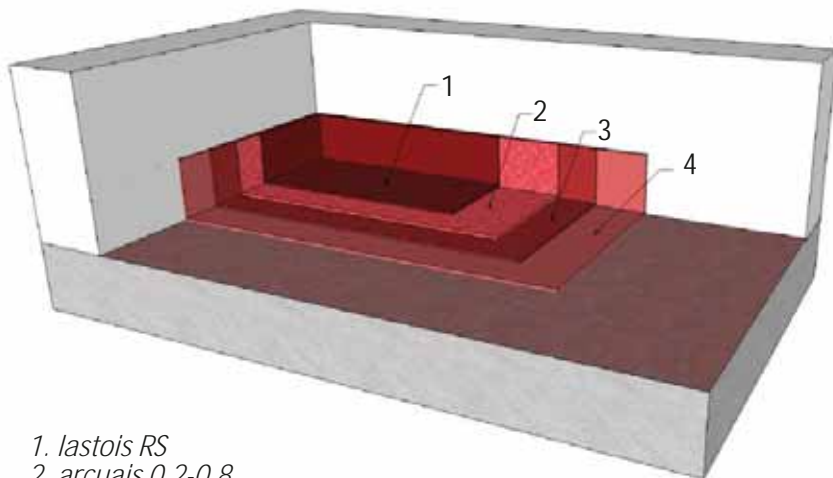

- 1. lastois RS
- 2. arcuais 0.2-0.8
- 3. lastois transi PU
- 4. lastois transi PU

Système imper-PRO

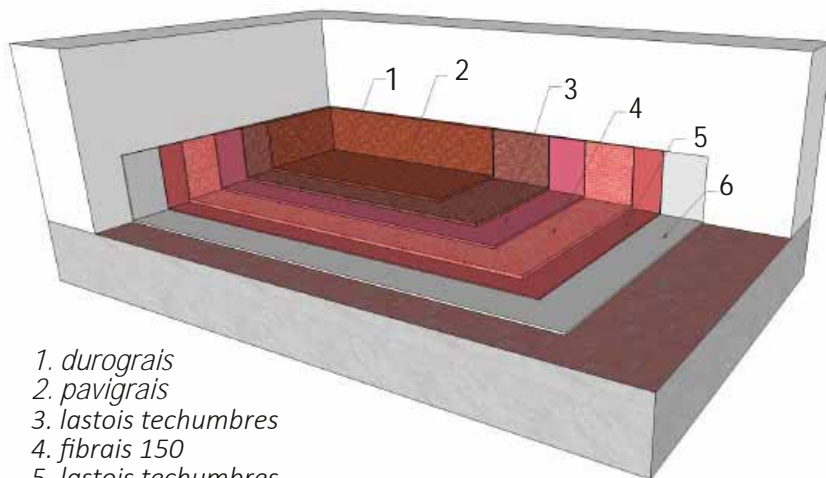

- 1. durograis
- 2. pavignais
- 3. lastois techumbres
- 4. fibrais 150
- 5. lastois techumbres
- 6. impridur

Waterproofing of gutters

Concrete and mineral substrates

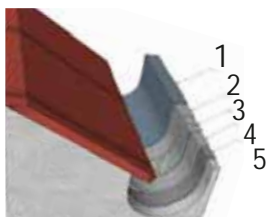

lastois techumbres

1. lastois RS
2. lastois techumbres
3. fibrais 150
4. impridur

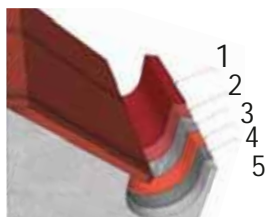

lastois canalones

1. lastois canalones
2. lastois canalones
3. fibrais 150
4. lastois canalones
5. impridur

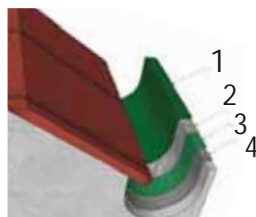

poliester N

1. poliuretano 80/20
2. fibrais 150
3. poliester N
4. impridur

Pvc - Galvanized sheet - Zinc - Copper

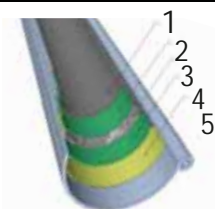

lastois techumbres

1. lastois RS
2. lastois techumbres
3. fibrais 150
4. lastois techumbres
5. teais pda

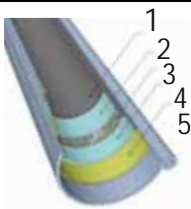

lastois canalones

1. lastois canalones
2. lastois canalones
3. fibrais 150
4. lastois canalones
5. teais pda

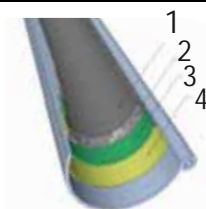

poliester N

1. poliuretano 80/20
2. fibrais 150
3. poliester N
4. teais pda

Iron



lastois techumbres

1. lastois RS
2. lastois techumbres
3. fibrais 150
4. lastois techumbres
5. brepois

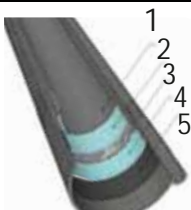

lastois canalones

1. lastois canalones
2. lastois canalones
3. fibrais 150
4. lastois canalones
5. brepois

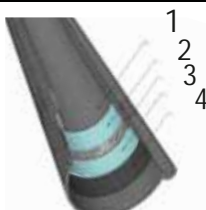

poliester N

1. poliuretano 80/20
2. fibrais 150
3. poliester N
4. brepois

TEAIS *Waterproofing gutters*

IRON				PVC - GALVANIZED SHEET-ZINC- COPPER				CONCRETE AND MINERAL SUPPORTS											
POLIESTER N	LASTOIS CANALONES	LASTOIS TECHUMBRES	PRIMER	1 st LAYER	2 nd LAYER	PROTECTION	POLIESTER N	1 st LAYER	2 nd LAYER	FINISHING	LASTOIS CANALONES	1 st LAYER	2 nd LAYER	FINISHING	LASTOIS TECHUMBRES	PRIMER	1 st LAYER	2 nd LAYER	PROTECTION



primers

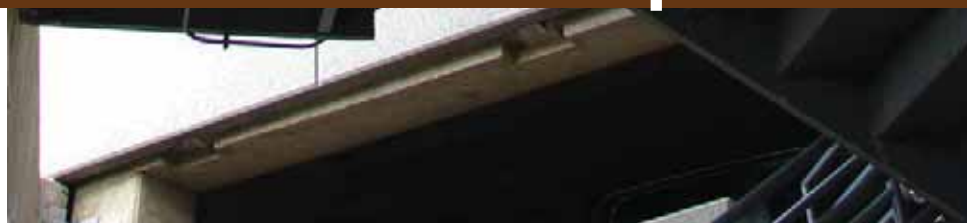

ANTI-GRAFFITI

antigrafitais

ANTICORROSIVES

epozinc

imprimación xp

oxitais

teais protecor N

metais GPB

imprimais mr

corrofin

autais impri

ac silver cr

STRENGTHENER

sellador adobe

endupis

WALLS

imprimais mu

imprimais

FLOORS

impridur

SEALING

fijopi

PROTECTION

epointer 90/10

PLASTICS

teais PDA

Learn more about our full range of products
www.teais.es

antigraffiti protector for stone and marble.

antigrafitaís

Antigrafitaís is a protector for surfaces such as stone and porous or matt marble, specially developed to removes easily the graffitis with GRAFITAIS cleaning agent.

It is used for protecting several supports from graffitis allowing an easier cleaning of the support with a suitable cleaning agent.



Packaging: 0,75 Lt, 5 Lt, 20 Lt
Consumption: 5 m2/lit and layer according to absorption

antigrafitti

3 component paint based on epoxi/zinc powder

epozinc

Epozinc with a concentration of 95 % of metal Zinc. Indispensable in systems that needs high anticorrosive protection such as: naval sector, industrial, etc. Ideal as an anodic anticorrosive layer for the subsequent painting with SHOP PRIMER (EPO-FOS).

It is applied in boats, metallic elements placed in marine environments, etc.



Packaging: 4 kg, 20 kg
Consumption: 6 to 8 sqm/kg layers of 30 microns

anticorrosives

imprimación XP

anticorrosive primer based on iron oxide fast drying



Imprimación xp is an antioxidant primer based on modified alkyd resins, iron oxide and reinforced with active antioxidant pigments. Designed for protecting all types of surfaces that can be damaged by corrosion such as metals made of iron. Especial for applying by spray gun.

It is used for protecting against corrosion on metallic surfaces made of iron, steel, light alloys, etc. It is specially formulated for applying by spray gun. Fast dry time.



Packaging: 4 l, 20 l

Consumption: 8 m²/l by dry film of 50 microns

oxitais

rust converter to iron protection



Oxitais is a liquid product that is used as a rust converter used for iron protection. It consists of an organic treatment that stops the rusting process immediately by also preventing the formation of new rust, thus neutralizing the surface.

It is used on metallic supports, cooling tanks, boilers, underground and air tanks, interior and exterior installations, etc. It is used as long as the surface to be treated only shows mild rusting.



Packaging: 0,50 l, 1 l, 25 l

Consumption: 15 sqm/l

protective coating and adhesion for concrete reinforcement with rust

**teis
protecor N**

This product is a two component product based on special microtextured resins and additivated with corrosion inhibitors.

Teais Protecor N is used as a protective layer for reinforcements in structure repair works, and provides an adequate adhesion layer over concrete and armor before applying repair mortars (Moris, Homifluis, Hormitix, etc..).



*Packaging: 1,5 kg, 8 kg
Consumption: 0,3 to 0,4 l/sqm*

anticorrosives

anticorrosive primer and paint

metais GPB

Metais GPB Antioxidant primer and paint based on synthetic resins and anticorrosive pigments design for the protection and decoration of all types of ferrous metals for indoors.

As primer and paint at the same time (only in indoors), on metallic surfaces made of iron or steel. On surfaces which are not made of iron or steel is necessary to do a previous treatment with IMPRIGALVI. In outdoors only is suitable to use as a primer on metallic surfaces made of iron or steel for subsequent finishing with a synthetic enamel such as ESMAIS OR ESMAR.



*Packaging: 0,75 l, 4 l, 20 l
Consumption: 7 sqm/l*

anticorrosives

imprimais MR

fast-dry antirust primer



Imprimais MR is an anti-rust primer based on modified alkyds resins, iron oxide and reinforced with active antirust pigments, designed to protect metallic surfaces that requires an immediate finish.

As a primer and protection of car bodies, truck cabins, vans, bikes, metallic structures, etc



*Packaging: 4 l, 20 l
Consumption: 5 sqm/l*

corrofin

antioxidant primer



Corrofin is a new generation antirust primer free of plumb, zinc chromate, zinc phosphahate or any other traditional inhibitor agents of corrosion and with an high antirust properties that even can be applied on surfaces slightly polluted by rust.

The product is used for aggressive environments or any application that requires a longer antirust protection in all environments.



*Packaging: 0,75 l, 5 l, 20 l
Consumption: 9 sqm/l per layer of 40 microns*

fast dry primer

**autais
impri**

Autais impri antirust primer based on modified alkyds resins, iron oxide and reinforced with antirust active pigments, specially designed for protecting metallic surfaces that requires an immediate finist.

As a primer and protection of car bodies, truck cabins, vans, bikes, farm machinery, tractor, etc.



Packaging: 0,75 l, 4 l, 20 l
Consumption: 4 sqm/l

anticorrosives

anti-corrosive primer

ac silver cr

Ac Silver CR is an one-component anticorrosive primer based on anticorrosive caoutchouc and pigments, suitable for ship hulls made of steel. For underwater body and air draught.

Used on ship hulls or elements which are in contact with marine waters.



Packaging: 4 l, 20 l
Consumption: 4 to 5 sqm/l

anticorrosives

sellador adobe

sealant and hardener for adobe surfaces



***Sellador adobe** is a dilution of synthetic resins that once applied on adobe, seal and hardens the surface allowing the transpiration at the same time.*

It is used as a sealant and hardener on the surfaces of adobe, in older constructions that requires a superficial consolidation to avoid the formation of dust and increase the durability.



Packaging: 1 l, 5 l, 25 l

Consumption: 5 sqm/l in two layers

endupis

hardener of natural and artificial stone and other porous supports



***Endupis** is a suitable product for the refurbishment of stone, slate, granite, etc. It produces the hardening and consolidation in the molecular structure of the material where is applied. Contains ethylsilicates partially hidrolized.*

For the consolidation treatment of stony materials. Refurbishment on older buildings made of stone. Refurbishment of decks made of slate. Treatment of stony materials to achieve a longer duration. Hardening of cement-lime- based renders with low hardening level. Improves the mechanical resistance of the materials both compression and traction. Increases the resistance to the alteration process. For outdoor and indoor.



Packaging: 5 l

Consumption: 8 sqm/l regarding support absorption

fixing and sealant solvent-based primer

**imprimais
MU**

Imprimais MU is a solvent-based primer, based on special resins made for fixing plastic paints (LASTOIS and water-based products in general) on not glazed dried supports, new covering or old paints.

On painted surfaces (indoors and outdoors) in good condition. When they are in bad condition with flakes, blisters, etc must be removed. On tiles, fibercement or similar. On old coverings and materials that requires superficial hardening. In general on all types of surfaces except glazed.

*Packaging: 0,75 l, 4 l, 20 l
Consumption: 5 to 7 sqm/l*



walls

penetrant sealer and fixer

imprimais

Imprimais is a penetrant sealer water-based that can be used as preparation of new supports. Makes easier the fixing and subsequent painting and at the same time reduces the quantity of paint to use. The paint looks more uniform by its action.

It is used as the preparation of primers in new covering, cement and gypsum. Seals and penetrates quite good.

*Packaging: 1 l, 5 l, 25 l
Consumption: 25 sqm/l*



walls

impridur

primer and hardener for cement surfaces



Impridur is a sealant-rehabilitator of surface hardness, epoxy resin based, designed to harden sills that are deficient in crazing, cracking, etc.. And primer coatings based on epoxy, polyurethane, and epoxy-polyurethane.

In industrial plant plots, food industry, vehicle repair workshops, marine loading docks, hangars, garages and parking lots, factories, bottlers, packagers, commercial locals and shops, as a primer for waterproofing application in low porosity media, which requires a better anchorage.



*Packaging: 2,5 l, 25 l
Consumption: 6 to 8 sqm/l*

fijopi

superficial hardener



Fijopi is a superficial hardener based on thin molecular-size special resins, designed to improve the superficial hardness on several supports.

It is applied on all types of sandstone and several supports that can be superficially disaggregated such as coverings, mud walls, lime-mortar joints, etc.

To harden in depth apply first ENDUPIS.



*Packaging: 0,75 l, 5 l, 20 l
Consumption: 6 to 7 sqm/l*

intermediate layer with barrier effect

**epointer
90/10**

Epointer 90/10 is an intermediate thick layer based on epoxi and inorganic pigments that is used as an antioxidant epoxy barrier. It can be repainted with epoxy systems or bitumen polyurethanes.

It is used on metallic structures where an high thickness on dry layer is required. It works as a barrier and increases the thickness of the layer on the protection system to use.



protection

Packaging: 6 kg, 30 kg
Consumption: 4 sqm/kg in 70 microns layers



cleaner agent and adherence improver for plastic surfaces or non-ferrous metals

teais pda

Teais PDA is a liquid based on active polymers that improves highly the adhesion capacity between support and covering.

Teais PDA is used as a primer on this supports:
Plastic, except teflon and polyethylene.

Old paints that are in good conditions for repainting on them.



plastics

Packaging: 0,75 l, 5 l, 20 l
Consumption: 15 to 20 sqm/l



METALLIC AREAS

Surface preparation for painting

A good preparation of the area to be treated is very important for the success of the protection of the metal structures and elements. In order for the painting to achieve the required objectives, it is essential that it adheres completely to the metal surface, this is obtained through an ideal preparation of the surface where you will apply the paint.

The majority of the defects in the coatings can be attributed to poor substrate preparation or poor adhesion of the coating. Cleaning the material of impurities like moisture, oils, greases, chloride salts, sulphates, dirt, oxides and corrosions provide an area more easily impregnable, fundamental for good adhesion.

The surface area is prepared using one or more of the following systems:

Chemical Cleaning: Cleaning with solvents to remove greases, oils, soil, salts, dirt and contaminants with solvents and detergents.

Passivisation: by means of the use of an anticorrosive primer such as Oxitais which stops the oxidation and neutralizes the oxide. Applies to lightly oxidized surfaces with mild atmospheric exposures.

Manual and Mechanical Cleaning (According to ISO 8501-1): It is classified by the letters St with the degree of intensity. Applies generally when there are small degraded areas, in areas that are not accessible by abrasive blasting, to eliminate layers of lamination, and any loose or poorly adhered paint.

Cleaning by abrasive blasting: (According to ISO 8501-1): It is classified by the letters St with the degree of intensity. This method is used for deep cleaning and removing

Degree St 2: Cleaning which removes layers of lamination, oxides and strange particles. Finally aspirate, clean with compressed air or clean brush.

Degree St 3: Equivalent to the indications of degree St2 but imminently, then remove surface dust, the support must have a clear metallic gloss.

Degree Sa 1: Light sandblasting to remove unbonded layers of lamination and oxides, as well as any strange particles.

Degree Sa 2: Careful sandblasting: Remove all layers of oxide lamination and strange particles, then clean with a vacuum cleaner for clean dust, compressed air or brush, the surface must be gray.

Degree Sa 2 ½: Very thorough sandblasting of the layers of lamination to remove perfectly, the allowable tolerance and simply corresponding to slight marks and stripes. Finally proceed to the elimination of any dust.

Degree Sa 3: Sandblasting to "white metal" totally eliminate layers of lamination, oxides and strange materials, thereafter remove dust from oxides and strange materials, after the removal of dust the metallic color obtained must be uniform.

PREPARATION OF THE SURFACE			PRIMERS							REINFORCEMENTS			FINISHING		SINGLE PROTECTION						
			OXIT AIS	IMPRIMACION XC	IMPRIMAIS MR	CORROFIN	SILVER CR	EPOZINC	TESIZINC	TEAIS-CAS	TEAIS-CHR	EPOINTER	ESMAIS	TEAIS-CHA	POLIURETANO 80/20	METAIS	PINTOX	FORJAIS	GALVAIS		BREPOIS OCULTO
CHEMICAL CLEANING	DEGREASING WITH TEAIS LAKA																			1	
																				3	
																				3	
																				4	
	DEOXYDATION WITH TEAIS ROKLIN																			4	
																				8	
																				2	
																				5	
PASSIVATION	LIGHTLY OXIDIZED METAL SURFACE																			5	
																				6	
																				1	
																				3	
																				3	
																				4	
																				8	
																				2	
PREPARATION ACCORDING TO ISO 8501-1	MANUAL AND MECHANICAL	St2																		6	
		St3																		6	
																				6	
																				6	
	CLEANING WITH ABRASIVE BLASTING	Sa1																			1
																					3
																					3
																					4
		Sa2																			8
																					2
																					6
																					6
		Sa2 1/2																			6
																					6
																					7
																					8
		Sa3																			6
																					7
																					8
																					8
																					9
																					9
																					7
																					8

More information available on
www.teais.es

TEAIS *floor preparation, surface preparation*

SURFACE PREPARATION										
	WITH POTHOLES	DUROAIS PARCHEO	DUROAIS CAPA CONTINUA	HORMIFLUIIS	EPOAIS 3F, TEAIS FRAME	DESINCRUSTOIS	DECAGRAS	DUREPOX TIXOTROPICO	DUREPOX AUTONIVELANTE	GRINDING AND SCRATCH
	WITH CRACKS									
	WITH GREASE									
	WITH IMPERFECTIONS									
FLOORS	NEW 28D									

TEAIS primers choices

For plastics, flooring, plaster and wood:

CHOICE OF PRIMER	CARCOMAIS		outdoor				indoor					IMPRIDUR	TAIS 50% DILUTED	IMPOL (BLUE)	POLUPLAST PRIMER
	WOOD	CARCOMA PROTECTION BACKGROUND TO PAINT	IMPRIFUN	IMPRIMAIS MU	IMPRIMAIS SUPER	LASTOSALIS	IMPRIMAIS MU	IMPRIMAIS	LASTOSALIS	HUMOTAIS	20% DILUTED PAINT				
PLASTER	PLASTER	NEW 28D													
		NEW 28D													
		PAINING ON PLASTIC													
		PAINING ON OIL													
FLOOR	FLOOR	POLISHED CONCRETE >28D													
		CONCRETE >28D													
PLASTIC	PLASTIC	PVC													
		POLYESTER													



FACADES

acrilais
pinsil d
teais homocolor
revetais
teais siloxano

INDOORS

humotais
pintis lisa
depis antimoho
antimohais

SWIMMING POOLS

pistais

PROTECTION

brepois
pintox
poliuretano 80/20
teais homiprotect
pincals

IMITATION

imade
rocais artístico

THERMAL INSULATION

teais termopin

FOOD INDUSTRY

epox aqua
epoais d

Learn more about our full range of products
www.teais.es

high strength and durability waterproofing paint for outdoors

acrilais

Acrilais is a waterproofing paint based on an aqueous dispersion of vinyl copolymers, made for indoors and outdoors surfaces decoration and protection.

In facades, inner courtyards, party walls, balconies, large fortified towers, domes, etc.

Onto fibrocement boards, cement mortar renders, gypsum, plaster, etc by priming previously.



facades



*Packaging: 5 kg, 25 kg
Consumption: 3 sqm/kg*

silicate based paint

pinsil d

Pinsil d is a paint based on silicate binders with inorganic pigments and inorganic fillers, very resistant to light.

The product is used in facades, adjoining walls, balconies, gables, cupolas, baseboards, etc. On new or old plaster, as well as lime cement, concretes, natural or artificial stone, fibro-cement, etc.

The supports must have the pore open before applying the paint. Ideal for restoration because it does not form a barrier, allows breathing, has an excellent lifespan, has a biocidal effect by its high PH. It does not form blisters due to moisture.



facades



*Packaging: 25 kg
Consumption: 3 sqm/l*

teis homocolor

special resin to homogenize and protect one-coat render mortars



Teais Homocolor is a resin with high adherence and excellent resistance to weather that improves and enhance the covering colours based on monolayer mortars.

Equalizes, homogenizes and intensifies color.

The product in addition to protect the facing from abrasion, wear, improving useful life and quality.



*Packaging: 5 kg, 25 kg
Consumption: 3 sqm/kg*

revetais

outdoor waterproofing plastic paint



Revetais is a plastic paint based on highly resistant inorganic pigmented copolymers, aqueous emulsion light stability, designed to decorate and protect the exterior surfaces.

The product is an ideal paint for facades both for repainting and for new, interior courtyards, adjoining walls, balconies, cupolas, etc.



*Packaging: 1 kg, 5 kg, 25 kg
Consumption: 3 sqm/kg*

waterproof siloxane-based paint and copolymers dispersion

**teais
siloxano**

Teais siloxano is a waterproof and water repellent paint for coatings, formulated based on acrylic dispersion copolymers and siloxanes.

The product is used for facade cladding and exterior cladding, interior courtyards, lime mortar facades, cement paint support, vertical surfaces and those requiring an upper water strength and vapor permeability than conventional paints.



facades



Packaging: 5 kg, 25 kg

Consumption: 4 à 5 sqm/l in two layers

synthetic paint for exposed areas to smoke and grease

humotais

Humotais is a paint based on thixotropic synthetic resins, which forms a synthetic enamel, made for painting slightly contaminated surfaces by fumes and greases without pre-cleaning.

It is used in ceilings and kitchen walls, bathrooms, boiler rooms, central heating rooms, poorly ventilated and smoke-laden atmosphere locals, stains and vapours in bars, restaurants, bakery ovens, etc.



indoors



Packaging: 0,75 l, 4 l, 20 l

Consumption: 8 sqm/l onto porous support

pintis lisa

washable plastic paint for indoors - outdoors



Pintis lisa is a paint based on resins and selected inorganic pigments, high light stability, made for decoration and protection of interior and exterior protected surfaces.

It is applied on ceilings and walls. On plasters and cement-based plasters, gypsum, asbestos cement, etc.



*Packaging: 5 kg, 25 kg
Consumption: 3 sqm/kg*

depis antimoho

indoor and outdoor plastic paint



Depis antimoho consists of a plastic paint based on vinyl copolymers, inorganic pigments. It is soluble in water and is formulated to decorate and protect supports in interiors exposed to mould and humidity.

It is used on walls and ceilings in interiors. Onto renders or cement based mortars, plaster, gypsum, perlite plaster, fibrocement, concrete slabs, etc.



*Packaging: 1 kg, 5 kg, 25 kg
Consumption: 3 sqm/kg*

indoor paint with conservators for mold control

antimohais

Antimohais is a paint specially designed for interior decoration by its composition which delays the process of mold formation.

The product is used as a preventive treatment in rooms with a high degree of humidity, such as in kitchens, restaurants, cafeterias, bathrooms, toilets, cloakrooms, gymnasiums, discotheques, garages, etc.



indoors

Packaging: 1Kg, 5 kg, 25 kg

Consumption: 3 sqm/kg



special paint for swimming pools

pistais

Pistais is a paint based on caoutchouc chloride, improved with high fastness pigments, resistant to moisture, alkalis and acids. Suitable for its application on pools.

On pools, water-tanks and tanks of both fresh and salt water. On cement-based mortar or similar. Finish on metallic surfaces and concrete affected by aggressive environments (proximity of the sea, industrial area).



swimming pools

Packaging: 0,75 l, 4 l, 20 l

Consumption: 2 to 3 sqm/l



brepois

two- component epoxy tar



Brepolis is a two-component epoxy tar that once is blended in proportion of 10 A / 1B on weight allows apply the product in thick coat avoiding dripping (150 microns per coat of wet film).

Ideal to cover and protect surfaces made of iron, steel or concrete against the moisture both weathering and buried.



Packaging: 5 kg, 22 kg

Consumption: 5 sqm/kg in 100 microns thickness

pintox

anti-rust enamel protector



Pintox is an enamel based on resins with special additives which provides to it anticorrosive properties.

It is used to paint on metallic surfaces, iron or steel (ferrous metals) where a primer is not required and repainting on rusted metallic surfaces removing just rust loose particles.

The product has excellent adhesion to almost all types of surfaces, can also be applied to non-ferrous metals without needing a primer.



Packaging: 0,75 l, 4 l

Consumption: 0,75 to 4 sqm/l

polyurethane based paint for indoors and outdoors

**poliuretano
80/20**

Poliuretano 80/20 is a paint based on polyacrylates and aliphatic isocyanates. With this combination finishes are obtained that are distinguished by their excellent gloss retention, light stability and chalking. Two component system.

The product is ideal for vertical cementitious surface cladding. Metallic structure in general. Interior or exterior floors.



*Packaging: 4 kg, 20 kg
Consumption: 5 sqm/kg*

protection

special resin-based paint for anti-carbonation protection of concrete

**teais
hormiprotec**

Teais Hormiprotec is a paint based on acrylic and special resin that fully protects the concrete against the carbonation, at the same time it constitute a decorative and durable coating.

It is used in new construction in which it is needed to give protection to anticarbonation concrete structure, in works where it has been made corrosion repair structures, etc.



*Packaging: 5 kg, 20 kg
Consumption: 2 to 3 sqm/l*

protection

pincals

lime-based paint



Pincals is a silicated-lime based paint based on greasy lime, micronized calcium carbonate and special additives. Very suitable both apply in building heritage or facilities where is wanted disinfection or deworming.

It is a mineral paint whose high PH makes itself very suitable to paint facilities such as farms, stables, dog-kennels, wineries, garages, basements, storage rooms, henhouses, industrial warehouses, closing wall. In these cases by its disinfectant and deworming effect. Also is very suitable to paint the tree trunks in its bottom part thus avoids the climbing of ants and other insects.



*Packaging: 20 kg
Consumption: 0,4 kg/sqm*

imade

wood effect paint



Imade is a paint based on synthetic resins that apply on mineral substrates such as concrete and mortars, provides a look similar to wood.

Its main applications are decoration both indoors and outdoors.



*Packaging: 0,75 kg, 5kg
Consumption: 5 sqm/kg*

synthetic cladding imitation granite stone

**rocais
artístico**

Rocaís artístico is a coating that imitates granite stone, specially developed for the decoration of surfaces, both inside and outside.

It is ideal for moldings, sculptures, outlines of doors and windows, facades, plaster cracks, etc.

The product consists of two phases, a color base and a layer formed by a gel with the particles in suspension.



Packaging: 0,9 kg, 4 kg, 18 kg

Consumption: Phase A; 4 sqm/kg; Phase B; 1 sqm/kg

imitation

thermal insulating paint

**teais
termopín**

Teais Termopín is a special paint specially formulated based on special resins and insulating micro-bubbles.

It is used for indoors and outdoors on mortar, concrete, plaster surfaces, etc. When are wanted to obtain thermal insulating properties, condensation decreasing, decrease thermal conductivity, energy saving, resistance to weather and to improve acoustic absorption.



Packaging: 4 kg, 18 kg

Consumption: 2 to 3 sqm/kg

thermal insulation

epox aqua**epoxy paint coating**

Epox aqua is a coating paint with soft odour based on epoxy resin and water as diluent that allows its application on surfaces in contact with liquids keeping their properties and taste.

For painting water tanks for domestic use. In school centres, clinics, slaughterhouses, food industry in general, etc.

Can not apply to bad weather.



Packaging: 1,5 kg, 9 kg
Consumption: 6 to 8 sqm/l

epois d**epoxy sanitary paint**

Epouis d is a two component epoxy paint based on epoxy resins and innocuous pigments. Fulfills the norm UNE-53550 global migration of waste in the medium (<10 mg/dm²) being suitable for contact with food.

It is used to slaughterhouses, butchers, fish markets, dairy and food industries in general, etc.

Not suitable for outdoor applications.



Packaging: 4 kg, 7 kg, 24 kg
Consumption: 7 sqm per kg layer of 50 microns.



STUCCOS

estucal

estucal satinado

ONE-COAT MORTARS

repois P

repois R

LIME MORTARS

revogacal R

revogacal

COLORED ARID COATINGS

grais

TEXTURED COATING

relais

relais siloxano

OTHER USES

minerplast

teais term

Learn more about our full range of products
www.teais.es

high-quality finishing paste stucco

estucal

Based-lime stucco for indoor and outdoor decorative finishes. Paste product that once applied presents a sleek finish with veined marble imitation.

Decoration of housings, shops, offices, cafes, hotels, very suitable for interior decoration of any construction.



*Packaging: 4 Kg, 19 Kg
Consumption: 1,6 sqm/kg*

stuccos

lime stuccos

estucal
satinado

Estucal satinado is a lime-based stucco for decorative finishes in interiors and exteriors. For exteriors, a layer of REPAIS as a protection must be applied. When it is applied has a smooth and shiny finish with veined marble imitation.

It is available in white color, and can be colored on request.

Decoration of houses, commercial premises, offices, coffees, heritage building refurbishments before the application of thin lime-based stucco such as ESTUCAL, etc



*Packaging: 19 Kg
Consumption: 1 to 1,5 kg/sqm, according to thickness*

stuccos

repois R

one-coat mortar with scratched finish



Repois R consists of a cement based external through coloured render. It is formed by a mortar that is freshly applied and allowed to dry partially. A special trowel is then used so as to obtain a decorative scratched finish.

According to standard UNE 998-1. DIT plus 627-17

It is used for rendering facades made of blockwork or brickwork. It also gives uniformity to new jobs performed on concrete, brickwork, etc. It is also used for restoring purposes so as to replace paints and plastic renders.

Packaging: 25 kg

Consumption: 20 to 22 kg/sqm

repois P

one coat mortar with projected arid



Repois P Continuous one-coat mortar coating, consisting of a base mortar that once applied and fresh, it's projected a bigger size arid that the one used in the mortar.

Fulfills norm UNE 998-1 Dit Plus 429-p

As coating masonry facades. To bring uniformity to a new work on concrete, concrete blocks, bricks, etc. Rehabilitation of tiling, replacing paint or plastic coatings.

Packaging: 25 kg

Consumption: Mortar 18 kg/sqm; Arids 10 to 12kg/sqm

rustic lime coating

revogacal rústico

Revogacal Rústico is a render with bonding agents based on lime, calcium hydroxide, selected aggregates with compensated particle-size bendings, additives that improve the workability, water-repellent additives and inorganic pigments.

To make base layers in refurbishment or based-lime mortars with several finishes such as estucco, etc



Packaging: 25 kg

Consumption: 1,4 kg/sqm per 1 mm thickness



lime mortar

traditional lime coating

revogacal

Revogacal is a traditional lime rendering consisting of a powder dry mortar.

REVOGACAL allows an excellent breathability of walls in constructions that provides healthy, dry and disinfected environments by the action of the lime and its high level of porosity.

It improves the energy saving because it reduces the heat dispersion from buildings.



Packaging: 25 kg

Consumption: 1,2 kg/m2 per 1mm thickness



lime mortar

grais

plastic resin coating with quartz seed

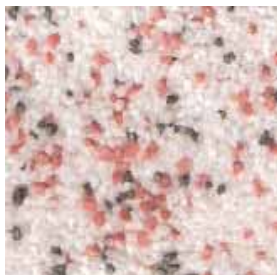

Grais is a continuous wall coating, for indoors and outdoors. GRAIS is a product based on granular marble, graded, cleaned, and mixed with synthetic resin provides the product a good adhesion, durability, washability and resistance to weathering.

Soapstone decorative coating for horizontal or vertical surfaces indoors or outdoors. Ideal for decorating facades, stores, stairwells, cafeterias, hotels, restaurants, etc..



Packaging: 23 kg

Consumption: 3 to 4 kg/sqm in 2 mm layer

relais

acrylic render finish with aggregate for indoor and outdoor



Relais consists of an acrylic texture coating system that is trowel-applied in interiors and exteriors. It is composed of vinyl resins and selectively graded aggregates and additives.

Highly decorative system available in two particle sizes: Thickness F: approx. 1 mm. Thickness G: approx. 2 mm.

Render for façades, courtyards, stairwells, both indoors and outdoors.



Specially recommended for our ETICS systems TEAIS TERM

Packaging: 25 kg

Consumption: F: 2 to 2,5 kg/sqm; G: 2,5 to 3 kg/sqm

acrylic and siloxane render finish for indoor and outdoor

**relais
siloxano**

Relais Siloxano is a textured stony cladding based on siloxane acrylic resins and selected charges. It is a cladding with an high decorative effect, waterproofing and breathable.

Can be applied on different supports, both on new and rehabilitation.

Specially recommended for our ETICS systems
TEAIS TERM



Packaging: 25 kg

Consumption: F: 2 to 2,5 kg/sqm; G: 2,5 to 3 kg/sqm

textured coating

embossed laminar coating imitation of cladding bricks

minerplast

Minerplast is a coating formed by stamped laminar pieces with different finishes such as facing brick, stone, slate, etc. The parts are realized with a stable veil and mineralized polymers.

It can be used as a facade cladding for cladding and stone brick, or as a cladding for terraces, as a finish for waterproof systems similar to slate.

It is a coating with very good aesthetic properties of high functional performance, durable, UV stable, resistant to abrasion and temperature changes, impact, etc.



Packaging: parts of 98x50cm

Consumption: 0,49 sqm/parts

other uses

teais term

thermal insulation system and external coating ETICS

Teais Term is a system of external thermal insulation, ETICS, which is supplied as a set of products and is used as thermal insulation of facades, both in new and for rehabilitation.

It adapts to the façade of the building, even if it has discontinuities, which makes it possible to solve most of the thermal bridges in a building. By allowing the incorporation of an optimal thickness of insulation, this system allows an energy saving of about 30%.

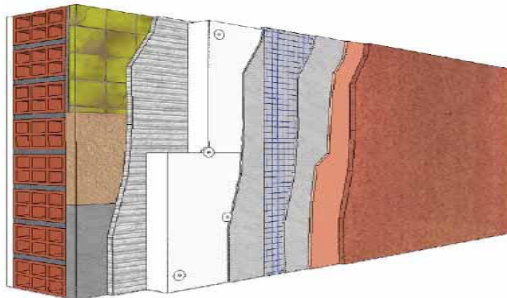

Teais Term system consists of the following products:

- Adhesive for the installation of thermal insulation panels. APOIS
- EPS insulation panels.
- Mortar layer for consolidation APOIS.
- Fiberglass reinforcement, Tejaais 5-150.
- Different finishing layer options:
 - **IMPRILAIS + RELAIS**
 - **IMPRILAIS + LASTOIS FHCV**
 - **IMPRILAIS + ROCAIS ARTISTICO**
 - **ADHESIVO + MINERPLAST**

*** REALIZED OUTDOOR**

*** DOES NOT REDUCE INTERIOR SPACE**

*** INCREASE VALUE OF THE HOUSING**

*** RECOVERING INVESTMENT IN 5 YEARS**

*** CAN APPLY DIRECTLY TO EXISTING COATING**



Sand finishing system that matches the aesthetics of a beach



The main characteristic of this system is the freedom of design and multiple possible shapes and depths. It adapts to all types of terrain. It is the ideal solution to realize the pool of your dreams.



The variety of possibilities of forms, allows to adapt to all types of terrains and even for the already existing swimming pools. It is therefore not necessary to carry out large construction projects to build a Swimming Pool beach in its garden.

vertical garden system for outdoor and indoor use

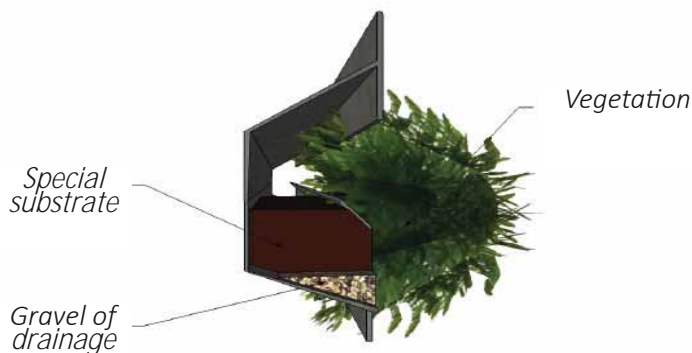

Teais Jardín Vertical is a vertical coating intended to contain the special enriched substrate that serves as a nutrient, promoting the development and durability of the vegetation.

The system is equipped with an internal watering that can be regulated as required. Another important advantage of the system is that the profile has a further profile space for luminous incorporation in the form of phosphorescent paint or low consumption light which may come from a solar source.



The system is applicable both in exteriors and in interiors and there is a possibility of incorporating insulation, which favors the thermal conditions of the space where it is installed.



POLYURETHANE FOAM

espumais

PLASTER PUTTY

autoemplais

ANCHORAGE PUTTY

fijopol

fijopox

BONDING AND SEALING PUTTY

lastois pol liquido

lastois ms

lastois pol

teais junplas

lastois spt

RENOVATION OF JOINTS

teais jun

ACRYLIC SEALANTS

lastois roca

lastois 10

teais juncril

PREFORMED JOINTS

junta laminar lastois

GROUTING MORTAR

rejuntais plus

rejuntais

HYDROEXPANSIVE SEALANT

lastois hidroexpan

expais jun

EPOXY SEALANT

epoais jun

virojun

OTHER USES

teais block

lastois psf

teais figrap

Learn more about our full range of products
www.teais.es

polyurethane foam

espumais

Espumais is a single component foam, self-expansible, very stable, polymerizes by air humidity, is thixotropic and without retraction. It is applied directly by foam-gun.

In the assembly of carpentry of doors and windows. For filling holes and cavities in holes and walls. For acoustic insulation. To fix insulating and decorative pannels. To optimize insulating and refrigeration works.



Packaging: 750 cc

Consumption: Aprox. 39 l per 750 cc package

polyurethane foam

plaster putty for metallic elements

autoemplais

Autoemplais is a plaster for two-component metallic elements that has an high power of filling, drying and ease of sanding once dry.

The product is used as a putty for metallic elements. It is mainly used for bodyworks in general, also for filling cracks and dents which require a filling with a high filling capacity compared to the depth to be closed.



Packaging: 1.5 kg

Consumption: According to use

plaster putty

fijopol

two component polyester-based resin for quick anchors



Fijopol is a two component polyester-based resin presented in tubes which the mixture of the components is performed in the extrusion process. It has a fast hardening, without shrinkage and with high mechanical resistance. Fijopol is a thixotropic product.

It is used for fixing anchors into solid supports such as concrete, stone, rock, or hollow brick and masonry.



Packaging: 300cc
Consumption: 1,2 kg per lt

fijopox

two-component epoxy resin for high resistance anchors



Fijopox is a two-component epoxy resin that comes in two tubes in which the mixing of components is done in the extrusion process. It hardens without retraction and achieve high mechanical resistance. FIJOPOX is a thixotropic product.

It is used for fixing anchors on solid supports such as concrete, stone, rock or hollows such as brick masonry.

It is used for maximum mechanical requirements.



Packaging: 300cc
Consumption: 1,3 kg/lt

sealant based on two component polyurethane resins in fluid consistency

lastois pol líquido

Lastois Pol Líquido is a two-component polyurethane resin of average density, high elasticity, high tack and very good filling capacity.

It is used in sealing joints of pavement, where high elasticity, good filling capacity, ease of application, high chemical and mechanical resistance is required.



Packaging: kit of 1kg, 10 kg
Consumption: 1,5 kg per lt of filled volume



bonding and sealing

neutral elastic sealant adhering to wet substrates

lastois ms

Lastois MS is a neutral curing putty sealant based on silane modified polymers. Without solvent and isocyanates.

Caulk with elastic properties, which adheres to most surfaces such as building glass, aluminum, concrete, plastics, PVC, metal, wood, shingles, etc.. Allows use on damp substrates with good adhesion. Indoors or exteriores. Resist to UV radiation (except the putty colorless)



Packaging: 310cc
Consumption: 12 ml per tube in 5 mm cords



bonding and sealing

lastois pol**elastomeric polyurethane putty**

Lastois Pol is an elastomeric putty-adhesive based on polyurethane, with high adhesive power and accelerated polymerization by environment humidity action, designed for flexible and watertight joints onto any kind of holder.

For fixing roof tiles, undulated asbestos cement decks, wood baseboards and skirting boards, sinks, metallic kitchens, etc. Flexible unions on decks, carpentry, installations, etc. Repairing pipes, ducts, etc. For bonding screens, partition walls, synthetic panels, etc. For bonding elements submitted to great efforts, impacts, PVC plates, etc.

Packaging: 300cc

Consumption: 12 ml in 5x5 mm joints

lastois spt**translucent polymer sealant**

Lastois SPT is a translucent polymer sealant that contains nanoparticles of silica.

It is used for sealing several types of surfaces mainly made of stone, works of wood, fissures, joints, in refurbishment and construction works. It can't be used as an adhesive.

Sealing where there is no permanent moisture.

Packaging: 300cc

Consumption: 1,3 kg/lt

modeling putty for bonding and sealing

**teais
junplas**

Teais Junplas is a sealant based on high-quality elastomers and plastomers.

Used for sealing contraction joints on polished concrete floors, printed concrete flooring, etc.



Packaging: 6 kg

Consumption: According to joints size

bonding and sealing

renovator and joint sealant

teais jun

Teais Jun is a sealant and renovator for joints in ceramic boards, tiles, marbles, etc.

The product is applied onto the joints as a marker which greatly simplifies the joints renovation.

It is used for all kind of joints in both ceramics and tiles, marbles, etc. Teais Jun is used in the renovation of bathrooms, kitchens, toilets, etc.



Packaging: 310cc

Consumption: 12 ml in 5x5 mm joints

joint renovator

lastois roca

special sealant for stone work

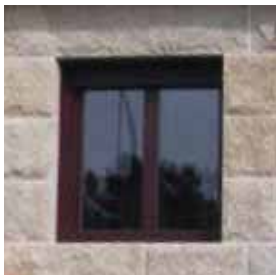

Lastois Roca is an elastic mortar sealant, with mineral and pigment charges. It has high resistance against atmospheric elements and UV radiation. The product when is cured becomes waterproofing, and once it is dry, allows painting on it with water-paints.

It is used for sealing several materials of construction such as frames, aluminium windows, wood, iron, PVC, etc.

It is used for filling and sealing cracks, joints, chimney finishes, fiber-cement, slate, etc. Plasteboards, prefab-concrete, stone pieces, marble, etc. It is suitable for sealing and finishing on ETICS because its plasticity and transpiration properties.

Packaging: 300cc

Consumption: 1,65 kg/l

lastois 10

water-based elastomer sealant



Lastois 10 is an elastomeric putty of one component based on acrylic resins with high adherence and elasticity that can be painted on once dry. It has anticorrosive properties and decreases the moss formation.

It is recommended for sealing joints whose permanent deformation is not over 10% of joint width (joint with few movement). For sealing in carpentry (aluminium, PVC, wood, etc). For sealing small cracks, plumbing, etc). Basically for interior joints with few movement. For sealing fissures in works of walls or facades repainting both for interiors and exteriors.

Packaging: 300cc

Consumption: 12 ml in 5x5 mm joint

acrylic, plastic and waterproof sealant in different colors

**teais
juncril**

Teais Juncril is a ready-to-use sealant based on acrylic resins, with a high strength and stability pigments, special additives and solar protectors.

Ideal for grouting natural stone, artificial stone, marble, granite, ceramic.

It is available in buckets, can be applied with a reloadable hand gun or ideally with our APLIJUN mortar applicator.



Packaging: 6 kg bucket

Consumption: 1,8 kg/mm/sqm

acrylic sealant

preformed band for sealing expansion joints

**junta laminar
lastois**

Junta Laminar Lastois is a preformed joint made of plastified PVC with lateral punches, special for the expansion joints sealed which require watertightness.

It is proper for the expansion joints sealed when their surfaces are irregular or have important movements and is not possible the use of conventional sealing products or it is no possible make the sealed by PVC joints like JUNTAIS.

It is used for tunnels, galleries, sewage treatment plants, terraces, swimming pools, around iron tubes, steels, concrete, cementings, along with great movements.



Packaging: 20 m

Consumption: 1ml per ml of joint

preformes joints

rejuntais plus

mortar for joint from 1 to 6 mm



Rejuntais Plus is a special mortar for sealing of ceramic, stone, marble, mosaic, granite, etc. seals.

The product has excellent adhesion properties, wear-resistant, mechanical strength, etc. By its characteristics, it is a very resistant product to apply in swimming pools.



Packaging: 1 kg, 5 kg, 25 kg

Consumption: F: 0,65 kg/sqm t= 5 mm

G: 1,3 kg/sqm t= 10 mm

rejuntais

joint sealer for tile and ceramics



Rejuntais is a special mortar that mixed with water makes a paste suitable for sealing of tiles, platelets, vitrous stuff, etc. Rejuntais has mixed cement-polymer binders, controlled retraction and contains special additives that improve its adhesion and impermeability.

(Verifies the norm UNE EN 13888 for CG 2 type)

It is used for sealing joints on floor and wall coverings, in indoors or outdoors, in bathrooms, kitchens, swimming pools, pavements in general, for its excellent glossy appearance is very suitable for coatings onto coatings based on porcelain tiles, marble, granite, etc.

With additives to prevent mold growth.



Packaging: 1 kg, 5 kg, 25 kg

Consumption: F: 0,65 kg/sqm t= 5 mm

G: 1,3 kg/sqm t= 10 mm

single component polyurethane for sealing in water presence

lastois hidroexpan

Lastois Hidroexpan is a product that reacts in contact with moisture, producing an increase in its viscosity, to achieve complete gelation and subsequent curing, which makes it ideal for sealing cracks and cavities with water infiltration, thanks to its properties proportioned a delayed cure allowing the product to benefit from the opening time required to fill the cavities by moving water optimally.



In the sealing and waterproofing of cracks and cavities with water leaks. In the sealing of underground work.



Packaging: 20 l, 5 l

Consumption: According to use

preformed hydro-expansive joint

expais jun

Expais Jun is a hydros swelling waterbar, ready for installation, to waterproof joints in concrete structures. The product is based on a special polymer technology that acts by swelling on exposure to water, to form a seal and render the joints leak-proof. EXPAIS JUN not lose properties after several cycles of dry-wet or after a prolonged period of moisture.

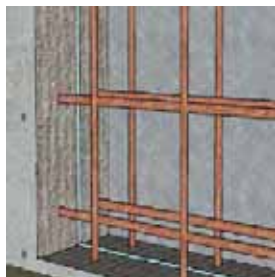

It is used to contain water leaks in concrete joints and on joints without movement.

The most common applications are screen walls, pillars in pile cap, and any union of concrete in contact with water, walls meetings with screeds, sealing penetrations in concrete, prefabricated elements. Cold joints in which sealing is required.



Packaging: 15m

Consumption: According to use

epoais jun

two-component seal of high chemical resistances



Epoais Jun is a two-component putty based on epoxi resins mixed with antiacid aggregates for filling joint on floors resistant to diluted acids and alcohol. Its application in chemical and food industry. It is manufactured in two ways of drying. The normal one (6 hours) and the fast one (1 hour and half).

As a joint sealant on floors of antiacid tiles. In any facility of chemical or food industry where a high conditions of cleaning and healthiness are required such as slaughterhouses, dairy plants, etc.

Made in two versions of drying, normal (6 hours) and fast (1 hour and 1/2).



Packaging: 4,5kg

Consumption: According to use

vitrojun

high-chemical strength glazed seal



Vitrojun is a glazed joint based on epoxy water-based resins of two components which blended have a doughy consistence.

It is suitable for grouting on floors or walls, domestic use, industrial, commercial and very suitable for using in hospital because of its ease of cleaning and no porosity. Suitable for areas exposed to chemical substances, environments with intensive transit, pools of new construction, grouting for refurbishment on existing pools, areas exposed to abrupt changes of temperature or freezes, etc. It sticks on surfaces covered with Gel Coat.



Packaging: 300cc, 1,5 kg, 7 kg

Consumption: 1,3 kg/l

elastomeric two-component self-leveling sealant based on polysulphide

lastois psf

Lastois PSF is a sealant based on polysulphide resins, elastomer and self-levelling. High chemical strength.

It is applied for sealing concrete joints, joints in permanent immersion, sealing of joints in canals, water tanks, floors of industrial warehouses, floors of stores, parkings, airports, joints in contact with chemical agents.



Packaging: 2,5 kg, 7,5 kg

Consumption: 100cc/ml for 10x10 mm joints

other uses

mortar sealant for installation of Teais grap dentada

**teais
figrap**

Teais figrap is a special sealant without shrinkage and high adhesion based on mixed binders rich in polymers, selected fine arid and with additives.

It's used for installation of Teais grap dentada, for stainless staples, for blocking cracks

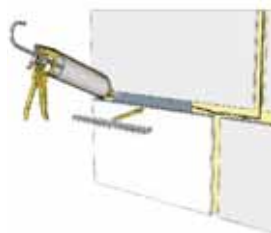

Packaging: 310cc

Consumption: 10-15 staples per tube

other uses

teais block

simplified system for crack blocking

Teais block is a system for sealing cracks by the realization of perforations and sealing by injections of special resins on different types of support.

The system is made of Teais block microexpansive sealant, stainless steel screens and grooved stainless steel frames.

In unions with structural parts, such as columns or beams.

Doing perforations, cleaning the same to remove dust, injecting resin into the perforations, and laying fresh sealant of the ribbed frame for each perforation.

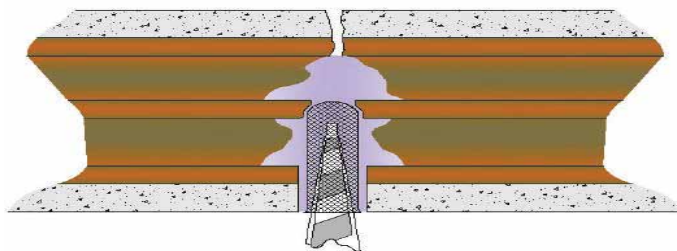

For cracks on hollow supports such as bricks or blocks, perforations should be made with a separation of approx. 15 cm, remove the dust, place the screens in the perforation and inject the teais block resin. Once dry remove the excess thickness, coat the substrate again and paint.

More information on teais block
www.teais.es

Packaging: 300cc

Consumption: 12 ml 5x5 mm joints



Teais IN101

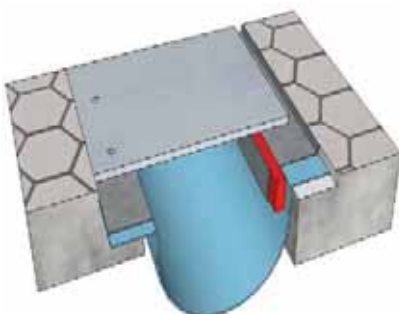

Teais IN102

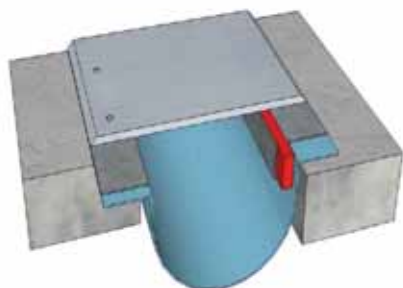

Teais IN103

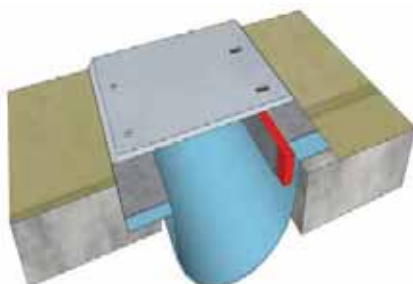

Teais IN104

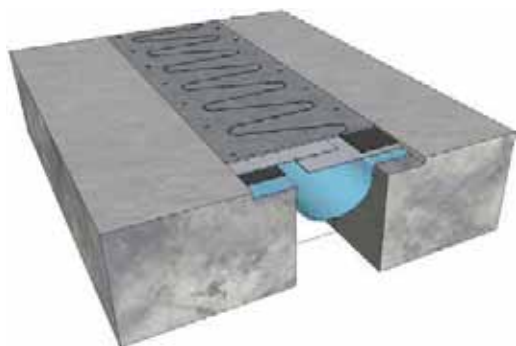

Teais IN105

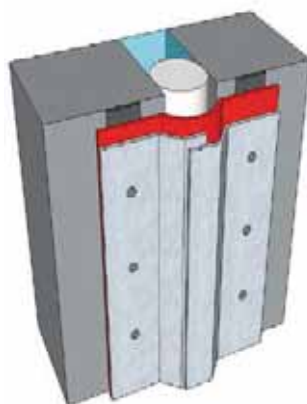

Teais Water-jun

*Specially designed to resist
To moisture by negative pressure*

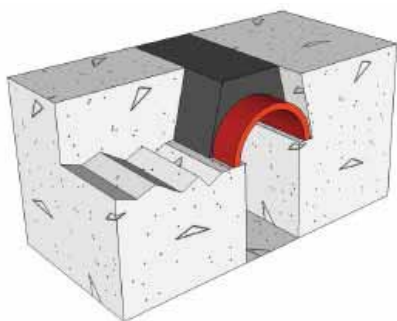

Teais IN201



Teais GTF 20.6

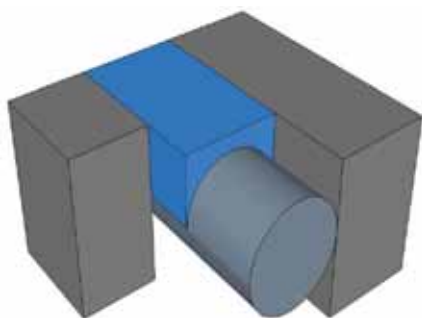

Teais B201

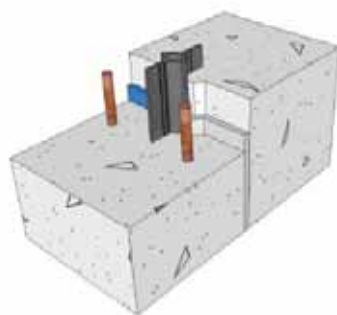

Juntais

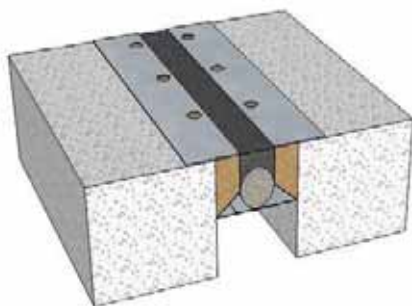

Teais IN 202

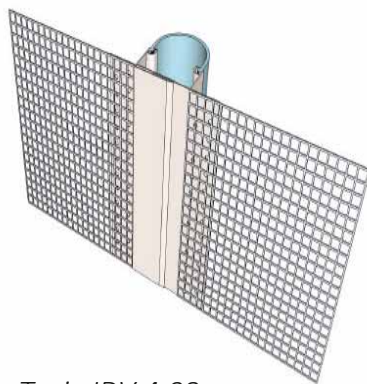

Teais JDV 4.08

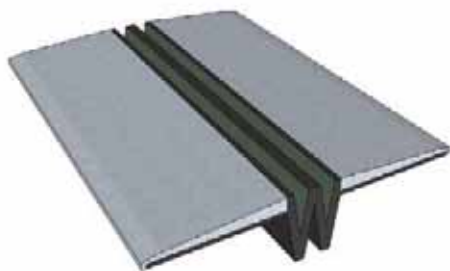

Teais JDH 5.32

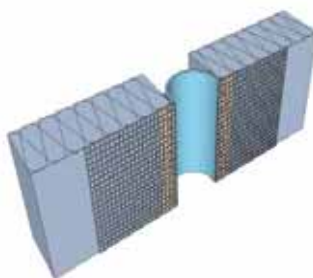

Teais Junta ETICS System

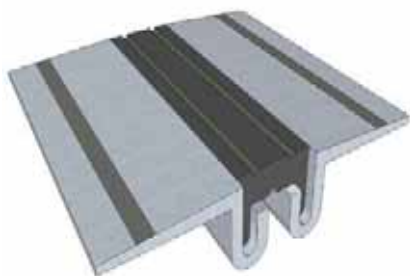

Teais RM20

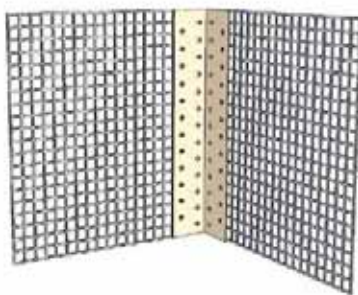

Corner reinforcement

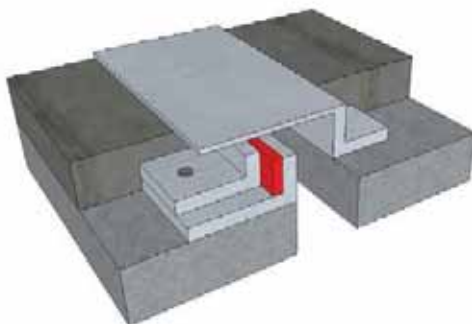

Teais JDH 6.32

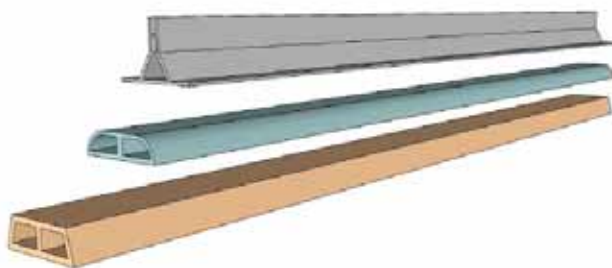

Juntis

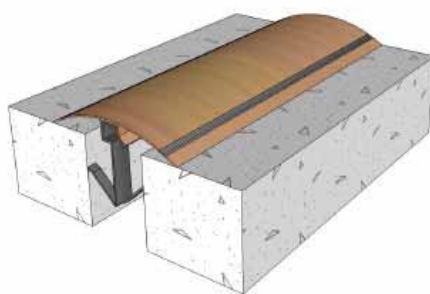

Teais Cubrejuntas Clip

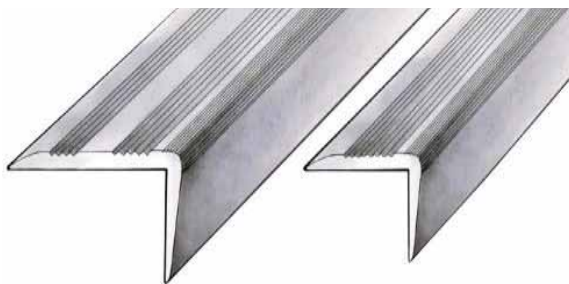

Teais NMD VD



floors



CURING LACQUER

lacuris d

CONTINUOUS RESIN FLOORS

durepox auonivelante

duepox tixotrópico

pavitaís pi

HIGH DECORATIVE FLOORS

teais microcemento

CEMENT FLOORS

durimprés

tradur

OUTDOOR DECORATIVE

durimprés rehabilitación

eslurris sintético

FLOORS PAINT

epoais pin

epoais vinicola

paviais ac

pinluris

tais

FLOORS PROTECTOR

pavilac

potector teais microcemento

resimprés

FLOORS REPAIRS

duroais capa continua

duroais parcheo

ANTI-SKID TREATMENT *ander-*

b

OTHER USES

teais pavimentos infantiles

Learn more about our full range of products
www.teais.es

curing lacquer for mortars and concretes

lacuris d

Lacuris d is a curing lacquer based on synthetic resins with solvents which forms a protective barrier that prevents the premature water evaporation of mortars and concretes.

It's sprayed onto mortar or concrete surfaces, mainly in summer time or high temperatures to prevent premature water evaporation and allowing an appropriated setting.

Very suitable for concrete highways and roads, airport runways, industrial pavements, precast elements, canals, etc.

Packaging: 5 l, 20 l, 200 l

Consumption: 8 sqm/l minimum



curing lacquer

self-leveling mortar epoxy-cement for repairs

durepox
autonivelante

Durepox autonivelante is a fluid consistence mortar made of epoxy resins and special charges, reinforced with polypropylene. It has a high mechanical strength and a fast commissioning.

It is highly suitable to repair industrial floor, rungs, charge and discharge area, docks, floors that a high resistance and a very good duration are required. As a temporally wall against the humidity before the application of coverings in floors that do not have a vapour barrier and they are into the ground. As a levelling layer to the application of resins floors, vinyl or wood floors due to its fast commissioning.

Packaging: 5 kg, 22 kg

Consumption: 1,8 kg/l



resin floor

durepox tixotropico

epoxy cementitious mortar for repairs



Durepox Tixotrópico is a thixotropic consistency mortar based on epoxy resins and special fillers, reinforced with polypropylene. High mechanical strength and quick startup.

It's applied in repairing industrial floors, pavements subject to high mechanical requirements, patching on stairs, ramps, loading areas, as an adhesive for a resistant gluing on wood or metal holders, etc.



Packaging: 6 kg, 24 g
Consumption: 1,8 kg/l

pavitaís PI

special epoxy resin for continuous floorings



Pavitaís Pi is a two-component epoxy resin with high solids contents.

For use in self-leveling continuous floors, antiskid finish floors, mortar-based floors, medium and high mechanical strengths.

For laboratories, food factory, hangars, loading dock, chemical industry, assembly industry, etc.



Packaging: 4 kg, 21 kg
Consumption: 2,5 to 3 sqm per kg of 300 microns layers

coating made with polymer cement microcement

**teais
microcemento**

Teais microcemento is a coating made with two components, cement and polymer with cement or polished concrete aspect, suitable for floors and coatings on multiple holders.

It has great possibilities for decoration and flooring, on the floor and on the walls.

It can be applied on tile tiles, on plasterboard, plywood furniture, etc.



Packaging: 4 kg, 20 kg

Consumption: 1 to 2 kg/sqm according to support

high decorative floors

coloring powder and surface hardener of stamped concrete floors

durimpres

Durimpres is a mineral powder hardener for stamped concrete with rubber molds. It is ready to use and colored, cement based, selected quartz arid, pigments and additives.

It provides color and surface hardness for stamped concrete floors. Its most common applications are entrances of garages, paths, parks, or gardens, external areas of public spaces, exteriors of urbanizations, etc.



Packaging: 25 kg

Consumption: 3 to 5 kg/sqm

cement floors

tradur

colored mineral hardener for making of concrete floors



Tradur is a solid product in powder and grain, which sprinkled over the surface of concrete slabs at the time of its construction provides a substantial increase in hardness rolling is formulated based on quartz aggregates selected, special binders, additives and pigments .

The product is used for car parks and garages. Industrial floors, loading and unloading areas, hangars, commercial areas, intensive pedestrian zones, streets, squares, courtyards, etc.



Packaging: 25 kg

Consumption: 2 to 3 kg/sqm

durimpres rehabilitación

predosed mortar for stamped concrete on thin layer



Durimpres Rehabilitación is a special mortar based on cementitious binders, quartz aggregates, pigments and additives. Specially for implementation of stamp concrete on thin layer.

Stamp concrete on thin layers from 1.5 to 2 cm thickness to apply on concrete floors or also on existing stamp concrete that are to be renewed.



Packaging: 25 kg

Consumption: 20 kg/sqm per cm of thickness

sports floor made of synthetic resins

**eslurris
sintético**

Eslurris sintético consists of a paste-like product made of a uniform mix of aggregates, graded mineral fillers and thermoplastic synthetic resin based emulsion.

Used as sealing material for asphalt agglomerate under construction and public works. For the finishing of parking areas and garages. For protection of light traffic area. For sports floors, garden paths, bike paths, garages, depots, etc.



Packaging: 25 kg

Consumption: 1 to 1,5 kg/sqm

outdoor decorative

epoxy floor paint

epoais pin

Epoais pin is a floor paint based on epoxy resins with high solid contents with very good properties of chemical and mechanical strength.

Suitable for painting floors in several applications such as garages, offices, industry, industrial buildings, stores, etc. It is not suitable for outdoor applications.



Packaging: 4 kg, 21 kg

Consumption: 0,5 kg per sqm in 2 layers

floors paint

epoais vinícola

sanitary epoxy floor coating



Is a two-component epoxy coating specially designed for food industry. Good resistance to wine, olive-oil, some solvents, hydrocarbon.

It is used in the food industry, mainly in wine sector, wine cellars floorings, wine vats, oil industry, mills, etc.



Packaging: 1 kg, 12 kg

Consumption: 1 kg per sqm of 300 microns film

paviais ac

industrial paint based on polyurethane and acrylic



Product formulated with polyurethane and acrylic resins, two components (base and reactor), designed to superficially harden and decorate concrete pavements and as anti-dust treatment. For indoor and outdoor using, considering that it may tend to yellowing in outdoors.

In the protection and decoration of concrete or mortar pavements in various applications such as;

- Industrial warehouses
- Sports courts
- Labs
- Hospital wards
- Computing rooms
- Exhibition centers
- Warehouses, food industries, etc.



Packaging: 6 kg, 30 kg

Consumption: 3 sqm per kg in two layers

acrylic floor paint

pinlurris

Pinlurris is a paint based on pigmented synthetic resins of high quality.

The product is used as a finishing paint by Eslurris Sintético on concrete and asphalt, such as tennis courts, industrial shed floors, garages, parks, urbanizations and chalets, sports grounds in general, etc.



*Packaging: 5 kg, 22 kg
Consumption: 5 sqm per kg*

floors paint

decorative protector and anti-dust treatment based on chlorinated rubbers

tais

Tais is a single-component product based on pure chlorinated rubber combined with mineral pigments with a very good light stability, conceived as a protective treatment, decorative and dustproof on concrete floors.

As finishing on fiber-cement sheets and concrete floors both indoors and outdoors, with waterproof properties, very good adhesion to building holders, resistant to alkalinity, for moderate traffic areas.



*Packaging: 0,75 l, 4 l, 20 l
Consumption: 3 sqm per l*

floors paint

pavilac

polyurethane varnish to protect and rehabilitate synthetic floors



Pavilac is a two-component polyurethane for refurbishing and protecting synthetic floorings (vynil, linoleum, etc).

PAVILAC is applied to renew the appearance of existing floorings or give an additional protection to new floorings, improving its durability and appearance.



*Packaging: 4 kg, 20 kg
Consumption: 5 to 6 sqm/l*

protector microcemento

special protector for thin pore surfaces



Protector Teais-Microcemento protector is a liquid product with low viscosity, high penetration, very high resistance to spots. Formulated with special resins, compatible with microcement and mineral supports.

It is used for protecting pavements, walls, worktops, etc

Cladding with TEAIS MICROCEMENT. Suitable in outdoors and indoors. It also can be used for the natural and artificial stone surfaces, etc.



*Packaging: 0,75 l, 5 l, 20 l
Consumption: 5 to 6 sqm/l according to support*

finishing resin for stamp concrete floors.

resimpres D

Resimpres D is a special solvent based resin specially formulated for the protection and finishing of printed concrete.

Is apply as a finishing resin to polished concrete floors, and stamp concrete floors. Provides a significant aesthetic improvement, and protects the surface improving its durability.



*Packaging: 5 l, 20 l, 200 l
Consumption: 8 sqm per l*

floors protector

continuous industrial flooring

**duroais
capa continua**

Duroais Capa Continua is a two-component products. One part is powder based on quartz aggregates, cement-based bonding agents and additives. The other part is liquid as a resin based on copolymers.

It is used to regularise sufaces (provided that the differences are not bigger than 5 mm) on floorings for garages, parkings, petrol-stations, etc



*Packaging: 31 kg
Consumption: 4,5 kg/sqm in 3 mm layers*

floors repair

duroais parcheo

industrial floor repair



Duroais Parcheo is a powder product that is mixed with water. To patching up on concrete floors. Based on cement-base bondings, quartz aggregates and additives.

It is used for filling potholes on concrete floorings that requires a good mechanical resistance and durability. For industrial facilities, stores, load and download areas, interior and exterior floorings, etc. Is very suitable to patching up and fillings in areas wheres subsequently regularization layers will be done with DUROAIS CAPA CONTINUA.



Packaging: 25 kg
Consumption: 1,8 kg/l

ander b

anti-skid chemical treatment for intermediate requirements



Ander B is a chemical antiskid flooring treatment based on active substances that generate a microporosity in the holder.

It is applied on moderate traffic areas which requires to avoid sliding. For indoor and outdoor pavements, in shower trays or non-plastic bathtubs. Ander B it's also used when you want to apply pavement paints on vitrified tiles, improving paint adhesion. Ander B can also be used as a previous step for the application of Ander F, when the application should be performed on vitrified holders to provide an adequate adherence for the treatment.



Packaging: 1 l, 5 l, 25 l
Consumption: 5 to 6 sqm/l according to support

elastic and continuous pavement system based on rubber and polyurethane resins

pavimentos infantiles

Teais pavimentos infantiles, is a continuous and elastic floor, ideal for playgrounds for children, etc. It is formed by rubber granules and is divided into two layers differentiated and bonded with a polyurethane resin **Teais pol SG**.

The system can be applied on rigid surfaces (concrete floors, terrazzo floors, asphaltic layers, etc.) which have an adequate slope for the evacuation of water.

It is recommended to apply Impridur beforehand to improve the adhesion of the substrate.

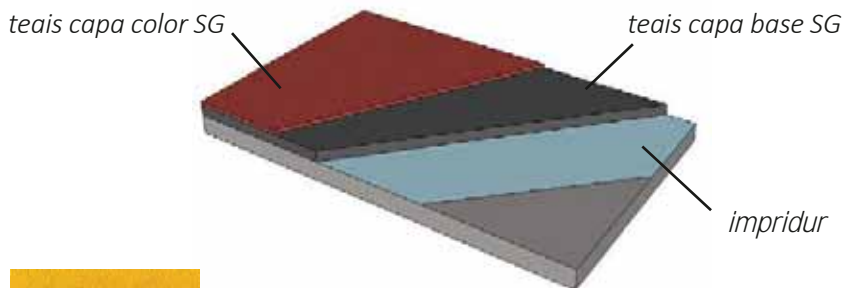

teais capa color SG
1-4 mm



teais pol SG



teais capa base SG
5-7 mm



impridur

For slabs with a vapour barrier

Pavitaís PI self-leveling

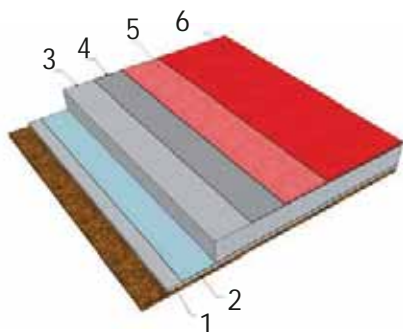

1. Concrete
2. Vapor barrier
3. Slab
4. Impridur
5. Pavitaís PI + arcuais 0.2-0.8
6. Pavitaís PI

Pavitaís PI antiskid

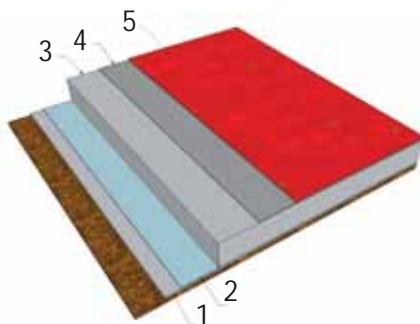

1. Concrete
2. Vapor barrier
3. Slab
4. Impridur
5. Pavitaís PI

Pavitaís Pi is a high performance resin for making floors that require chemical, mechanical and aesthetic properties.

Ideal for creating floors of various types, with a smooth or non-slip finish.

From the point of view of chemical resistance, floors made with Pavitaís Pi have high resistance to various chemicals, so it is particularly suitable in environments and premises where there may be accidental discharges, as well as in toilets, bathrooms, kitchens, work areas, etc. It is also very resistant to cleaning products.

Its mechanical strength is extraordinary, it is the ideal coating for areas of intense work.

It is available in a wide range of colors, thus being able to adapt to all the projects of decoration.

The Pavitaís Pi floor system is a very diverse solution, both for the naval industry, foodstuffs, all types of industries in general.

For slabs without a vapour barrier

Pavitaís PI self-leveling

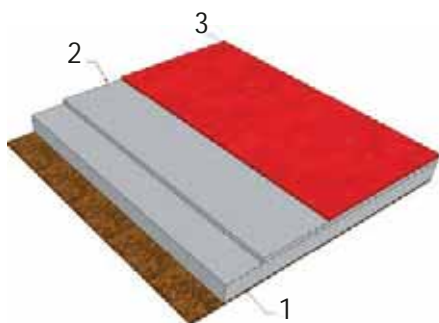

1. Slab
2. Durepox autonivelante
3. Pavitaís PI + arcuais 0.2-0.8

Pavitaís PI antiskid

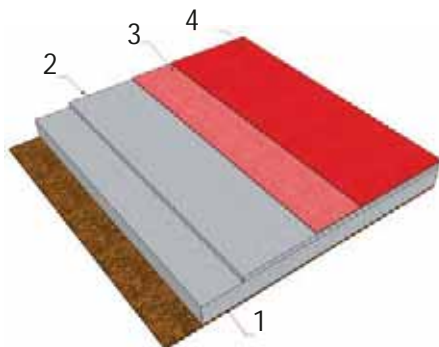

1. Slab
2. Durepox autonivelante
3. Pavitaís PI + arcuais 0.2-0.8
4. Pavitaís PI

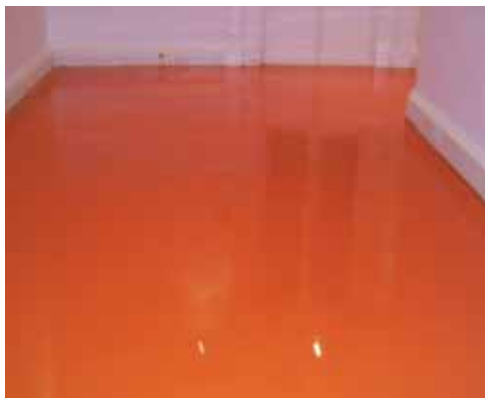

Poliuretano 80/20

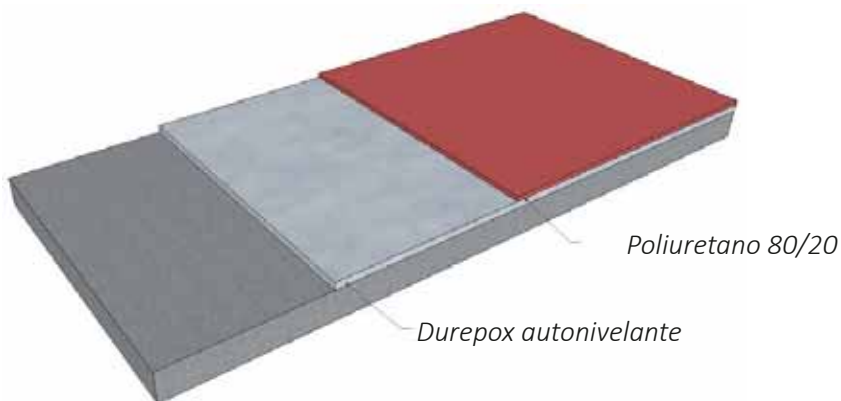

Tais

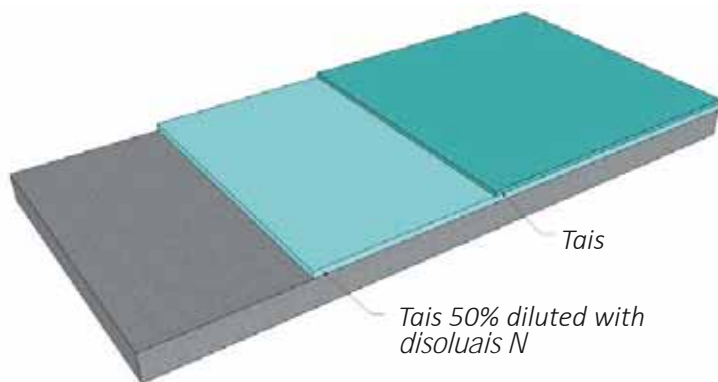

Tais antiskid

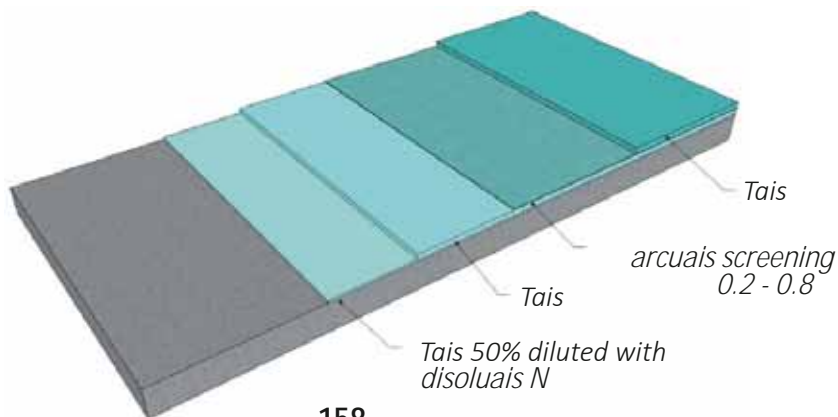



wood line



PROTECTION

teais lasur

INSECT PROTECTION

carcomais

REFURBISHMENT

madepois líquido

madepois pasta promadis

emplais m

Learn more about our full range of products
www.teais.es

protector and decorative lasur for wood

**teais
lasur**

Teais Lasur is a protector based on solvents for wood exposed to weather, moisture, insects. Long life product and excellent resistance to the weather.

For protecting all types of wood exposed to the weather, gardening furniture, wooden pavements, street furniture, etc. Protects the wood from the effects of the sun, rain and moisture. Its formulation is specific for a long durability and optimum protection against the weather.

The application of TEAIS LASUR enhance the natural veined of wood. It lets wood transpire because it a open pore protection.

Packaging: 0,75 l, 5 l, 20 l

Consumption: 8 to 10 sqm per l and per layer



protector

protective liquid against wood borers

carcomais

***Carcomais** is a liquid based on biocide substances made for destroying wood borers, vegetal parasites, fungus and rotting by its preventive application, protecting the wood even under the weather.*

For the protection of frames, doors and windows. Shutters, and wooden rolling courtyards. Furniture, decorations, flats, structures, stairs, handrails, balustrades, fences and wooden art items.



insect protection

Packaging: 0,75 l, 5 l, 20 l

Consumption: 4 to 6 sqm/l

emplais m

filler for wood



Emplais M is a solvent-based filler for wood. It doesn't shrinkage after its application. Available in more common colours of wood.

For smoothing on wooden surfaces. For eliminating cracks, holes, fissures and faults in general.



Packaging: 0,135 cc

Consumption: according to use

made pois líquido

fluid epoxy adhesive for the cohesion of wooden elements



Madepois Líquido, is a product formulated as a filler paste and high power adhesive based on epoxy resins, wood flour and free of solvents that mixed just in the moment of using allows refurbishments and the sticking between wood pieces or to another type of material such as concrete, stone, etc...

As an high power adhesive in the joint between pieces of wood, wood with concrete, wood with stone, etc. In works of reparation and refurbishment of wood, for small replacements where good mechanical resistances are required and also high adherence. For the refurbishment of beams or pillars made of wood using reinforcements based on fiberglass.



Packaging: 6,5 kg

Consumption: according to use

thixotropic epoxy adhesive for wood

**madepois
pasta**

Madepois Pasta, is a product formulated as an adhesive of high adherence based on epoxy resins, wood flour and free of solvents that mixed just in the moment of using allows the sticking of wood pieces or wood with concrete, stone, etc. Specially developed to recompose structural sections of wood using as well fiberglass reinforcements.

As an high power adhesive for joining pieces of wood, wood with concrete, wood with stone, etc. In works of reparation and refurbishment of wood such as beams and pillars.

Packaging: 6,5 kg

Consumption: according to use



refurbishment

pore covering agent for wood

promadis

Promadis is a protector agent for wood based on synthetic resins in aromatic solvents, with special additives to avoid diseases on wood.

As a pore covering agent for wood. Is an ideal preserver as a first layer for raw woods, avoid bluish, root and with an high power of penetration. It always must be protected subsequently with varnist such as PROMADIS DECOR or paint such as ESMAIS

Packaging: 0,75 l, 5 l, 20l

Consumption: 10 to 12 sqm/l



refurbishment

wooden trusses with section repair

Deteriorated wooden beams on which is realized a repair of part of the section with *madepois*, and an armature of fiberglass rods *Armasín*. Depending on the fluidity required during the application you can use *Madepois líquido*, or *Madepois pasta*.

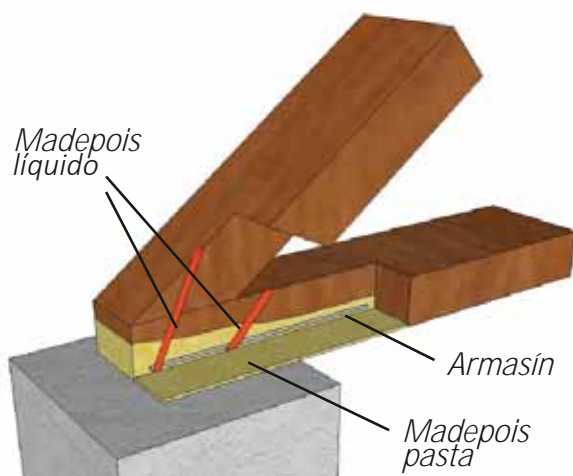
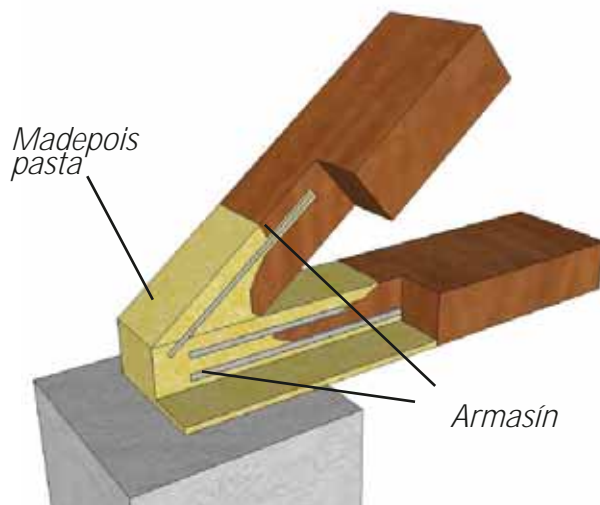



refractory line

REFRACTORY CONCRETE
teis hormi-ref

REFRACTORY FIBER
teis mod-cer

REFRACTORY PAINT
teis pin-ref

REFRACTORY ADHESIVE
teis pasta refractaria

REFRACTORY PAPER
teis pap-cer

Learn more about our full range of products
www.teais.es



They are specially developed concretes to withstand high temperatures in various industrial processes, from the ceramic industry to the steel industry, aluminum, etc.

The main refractory concretes available are:

Teais Hormi-Ref B

Refractory concrete with a bauxite base, dense, highly resistant to abrasion and at temperatures up to 1550°C.

Can be used for various applications with iron and steel,

Used for various applications such as foundries and boilers, vulnerable areas such as doors, frames, where strength and resistance to abrasion are important.

Teais Hormi-Ref P

Refractory concrete with low cement content and temperatures up to 1400°C.

Used frequently as prefabricated, to substitute refractory bricks with special shapes. For special parts of boilers, and furnace bases for example.

Teais Hormi-Ref A

Aluminum-based refractory concrete with high chemical purity, high strength, hardness and abrasion resistance, resistance to temperatures up to 1850°C in suitable atmospheres.

Used in the petrochemical industry and in the production of fertilizers. Also in cases where the temperature may be low, but the materials are very aggressive as for the melting of copper and brass.

**teis
mod-cer**

ceramic fiber modules



The ceramic fiber modules are produced by a compressed ceramic cover. Specially developed to improve the thermal insulation of industrial furnaces and other applications.

These modules are produced with different types of enchorage when they are required for its ease and efficiency in the installation and coating of the majority of furnaces.



Packaging: 300x300mm modules

Consumption: according to use

**teis
pin-ref**

paint based on refractory minerals



Suitable for areas requiring a refractory protective layer.

For example, for molds and spoons of the metallurgical industry, etc.

Resistant to temperatures up to 1750°C



Packaging: 30 kg

Consumption: 1kg/sqm

adhesives for high temperatures

teais pasta refractaria

Special adhesive for the installation of coatings and refractory parts on supports which rise at high temperatures.

The product is ready to use in paste form and can withstand hardened temperatures of up to 1700°C.



adhesive

*Packaging: 25 kg
Consumption: 1,8 kg/m² per mm of thickness*



ceramic paper

teais pap-cer

Ceramic fiber paper is a light refractory material that is a mixture of silica fibers, high purity alumina turned into a flexible and uniform membrane.

It is recommended for temperatures of up to 1260°C.

The paper has a low shrinkage, high resistance to use and low thermal conductivity. Low release of gas and odor during operation.



paper

*Packaging: 40m (t=1mm), 15m (t=3mm),
10m (t=6mm)*

Consumption: 1,05sqm/sqm



aplijun

motorized gun for grouting and application of mortar

Aplijun Is the ideal tool for the application of mortars and grouting materials for: stone joints, joints of ceramic materials, on walls and floors, for anchorage fixing mortars, grouting of different materials, etc.

Aplijun is available in two models: *Aplijun Battery* and *Aplijun Corded*

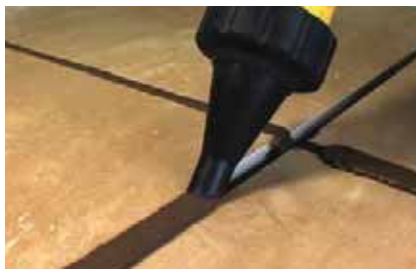

Grouting stone

Grouting brick and tiles



APLIJUN *Battery*

- 2 batteries 18v
- Hopper 3Kg



APLIJUN *Corded*

- Corded 400w
- Hopper 3Kg



NOTES:

This image shows a full page of blank primary-ruled paper. It features multiple sets of horizontal lines designed for handwriting practice. Each set consists of three lines: a solid top line, a dashed middle line, and a solid bottom line. These sets are repeated vertically down the entire page, providing ample space for practicing letter formation and alignment. The paper is otherwise completely blank, with no margins, text, or other markings.

NOTES:

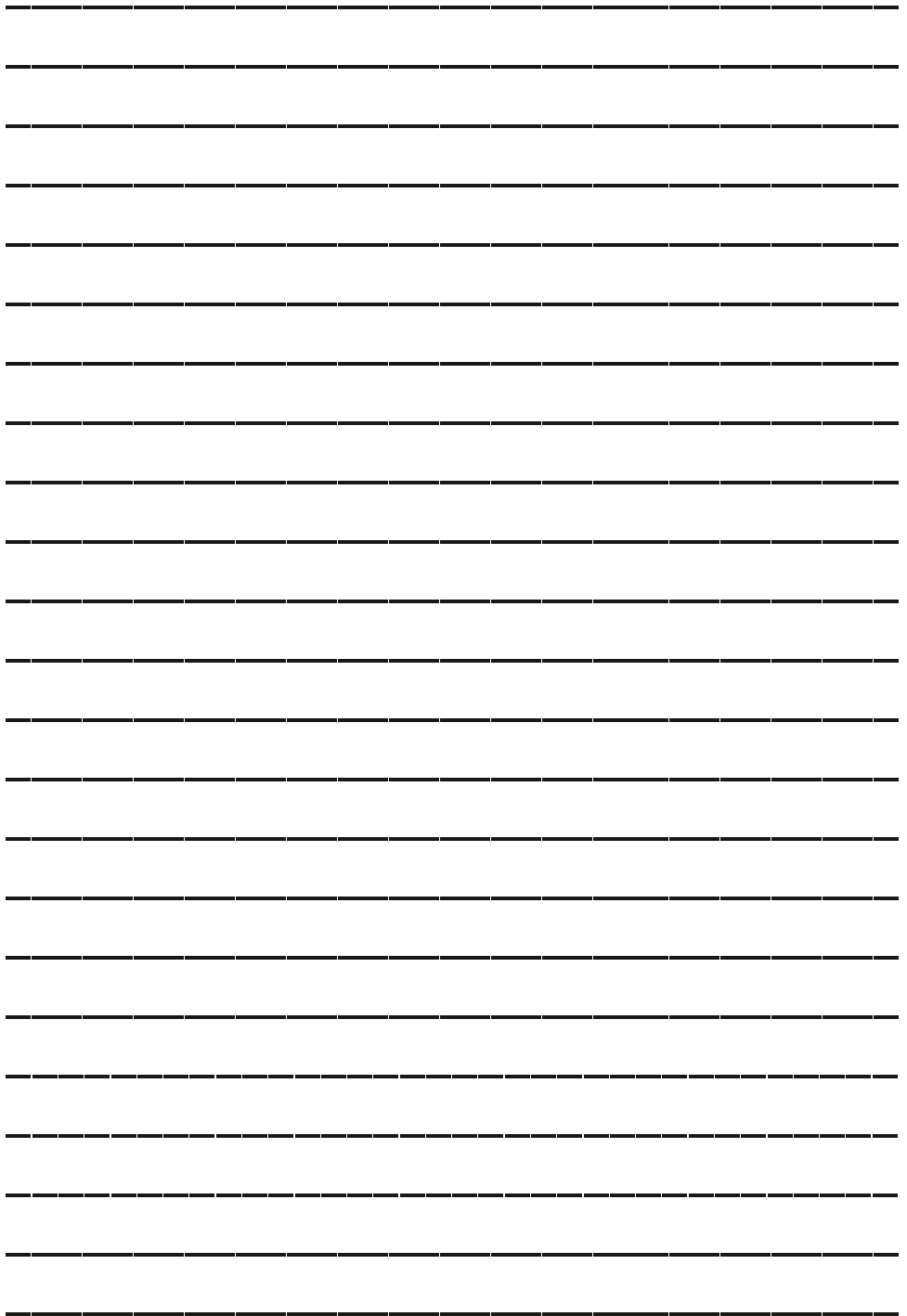



www.teais.es

© TEAIS S.A. - Avda. da Enerxía, nº153 Pol.Ind de Sabón - 15143 Arteixo, A Coruña
Telf.: +34981 60 21 11 - Fax: +34981 60 15 08 - E-mail: info@teais.es